

'BG' Raised Panel Shaper Cutter

Aluminum alloy head with 2-sided replaceable carbide knives. Manufactured to strict "BG" specifications, which limits the chip thickness for a safer, more controlled cut. For use with 1-1/4", 1" or 30mm spindles only. Standard bore is 1-1/4". Includes 3mm T-Handle hex key.

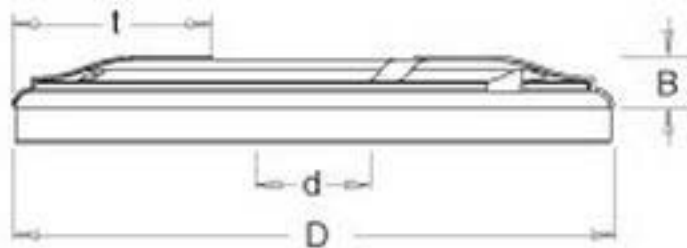

| D | B | Tool No. | L | d | RPM Ideal/Max |
|------------|-----------|----------|---------------|--------|---------------|
| 180MM (7") | 25MM (1") | 61262 | 60MM (2-3/8") | 1-1/4" | 4200/7000 |

Replacement Parts

| Order No. | Description | Size | Qty. Required |
|-----------|---------------------|---------|---------------|
| RCK-78 | Pair carbide knives | 60MM | 1 |
| 67144 | Allen screws | 8x1.0MM | 4 |
| WB-10 | Wedge blocks | --- | 2 |
| 5012 | T handle hex key | 3MM | 1 |