

## 'BG' Raised Panel Shaper Cutter

Aluminum alloy head with 2-sided replaceable carbide knives. Manufactured to strict "BG" specifications, which limits the chip thickness for a safer, more controlled cut. For use with 1-1/4", 1" or 30mm spindles only. Standard bore is 1-1/4". Includes 3mm T-Handle hex key.

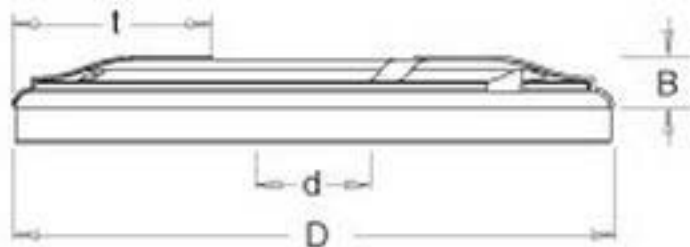

D	B	Tool No.	L	d	RPM Ideal/Max
180MM (7")	25MM (1")	61262	60MM (2-3/8")	1-1/4"	4200/7000

### Replacement Parts

Order No.	Description	Size	Qty. Required
RCK-78	Pair carbide knives	60MM	1
67144	Allen screws	8x1.0MM	4
WB-10	Wedge blocks	---	2
5012	T handle hex key	3MM	1