

<b>GEOMETRY</b>
2 Wing(s)
10° Hook
5° Shear

Setup for profile B 1.75" wood

1. Spacer 1.1115" thick
2. Body 327A with insert 340
3. 1.25 x .005 shim
4. Brazed groover body 332
5. 1.25 x .005 shim
6. Body 327E with insert 341
7. End cap

The minor diameter is 90mm

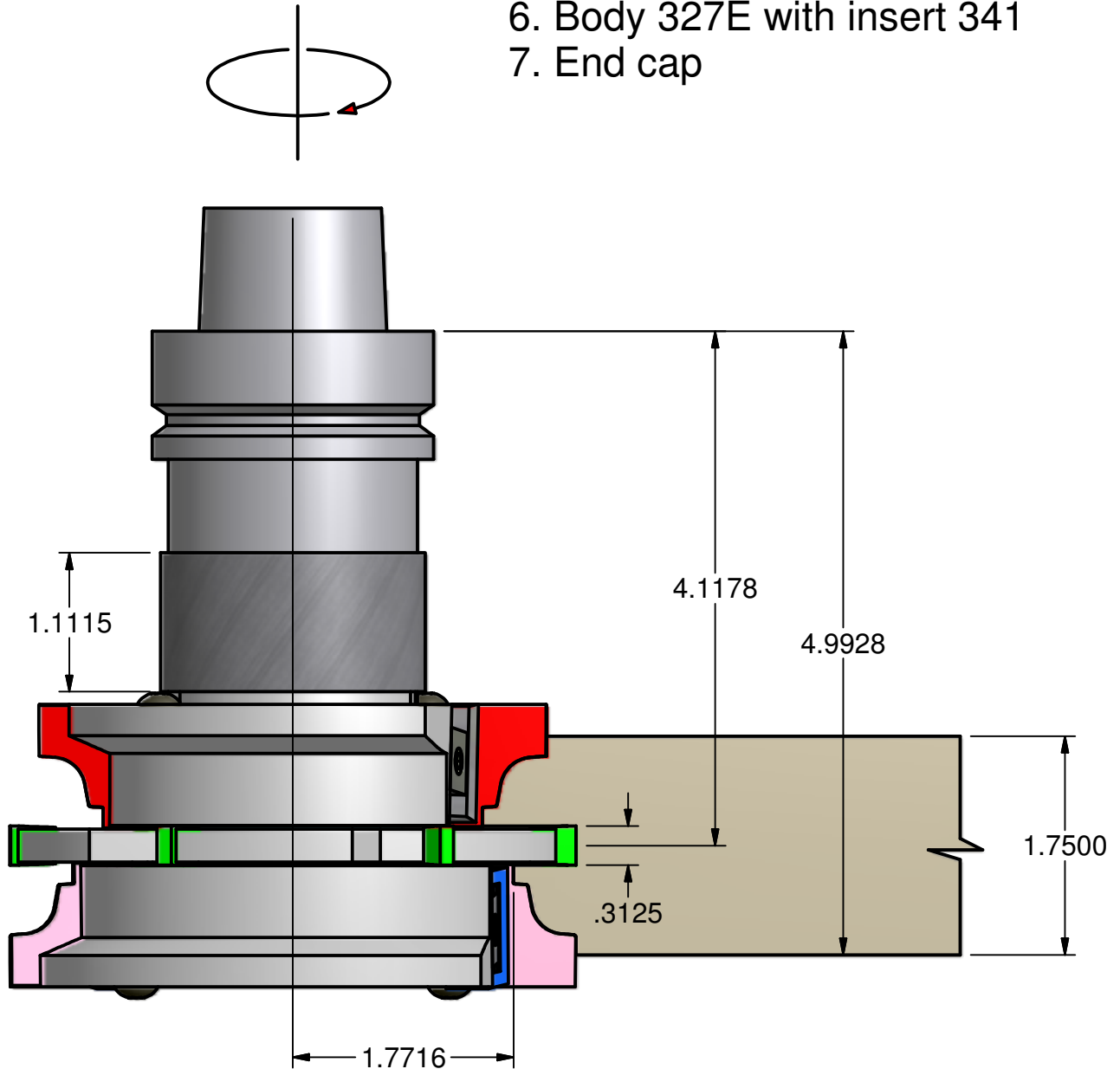

THIS DRAWING IS PROPERTY OF EW TOOLING, INC. AND MUST NOT BE USED IN ANY WAY DETRIMENTAL TO OUR INTERESTS

## PARTS LIST DRAWING

**E.W. TOOLING, INC.**  
Cutting tools for the woodworking industry

Originate: 12/09

Last edit: 12/14/09

EW P/N: 182-327

Tips: Carbide inserts

Cust P/N: Profile B for 1.75" wood

<b>GEOMETRY</b>
<b>2 Wing(s)</b>
<b>10° Hook</b>
<b>5° Shear</b>

The minor diameter is 90mm

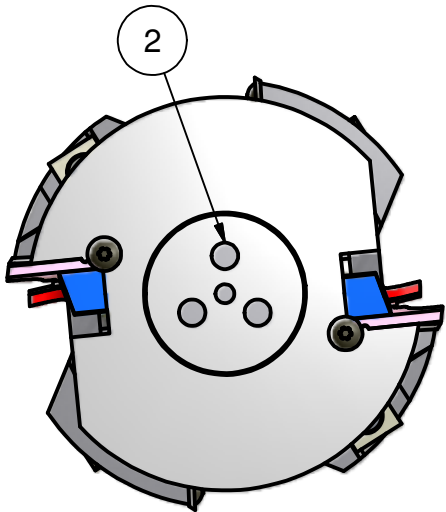
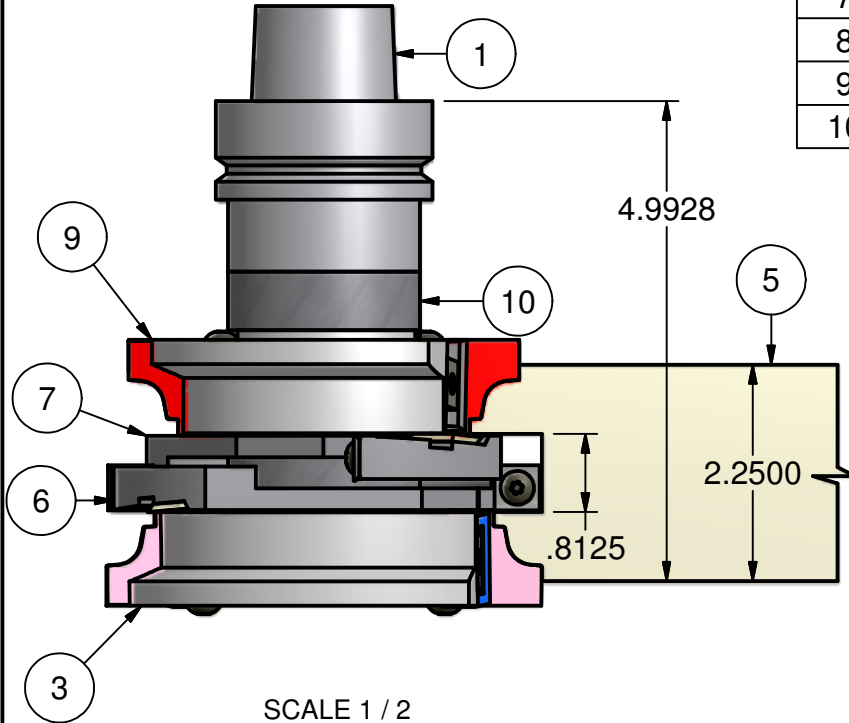

Parts List		
ITEM	QT	PART NUMBER
1	1	Lacey 1.250 toolholder
2	1	Lacey Toolholder Small Endcap
3	1	182-327 CW body E assembly
5	1	Stile B 2.25" wood
6	1	182-327 Groover body C assembly
7	1	182-327 Groover body B assembly
8	1	182-327 Groover spacer for 2.25 B
9	1	182-327 CW body A assembly
10	1	182-327 Top spacer for 2.25 B

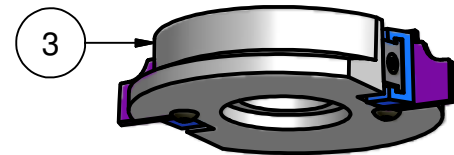
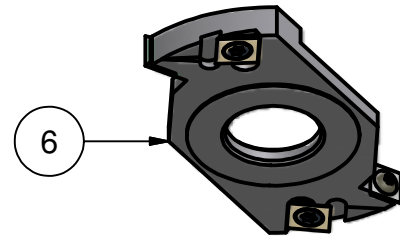
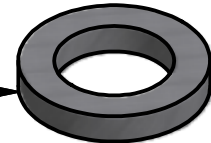
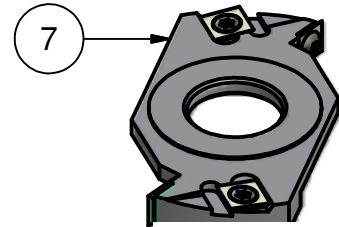
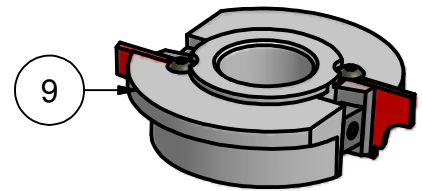

THIS DRAWING IS PROPERTY OF EW TOOLING, INC. AND MUST NOT BE USED IN ANY WAY DETRIMENTAL TO OUR INTERESTS

## PARTS LIST DRAWING

**E.W. TOOLING, INC.**  
Cutting tools for the woodworking industry

Originate: 12/09

Last edit: 12/14/09

EW P/N: 182-327

Tips: Carbide inserts

Cust P/N: Profile B for 2.25" wood

<b>GEOMETRY</b>
2 Wing(s)
10° Hook
5° Shear

The minor diameter is 90mm

Parts List		
ITEM	QTY	PART NUMBER
2	1	Lacey 1.250 toolholder
3	1	Lacey Toolholder Small Endcap
4	1	182-327 CW body E assembly
5	1	182-327 CW body A assembly
6	1	Stile B 1.75" wood
7	1	182-332 groover for 1.375 stile
8	2	Shim 1.25x1.75x.005 (not shown)
9	1	182-327 top spacer for Prof.B 1.75

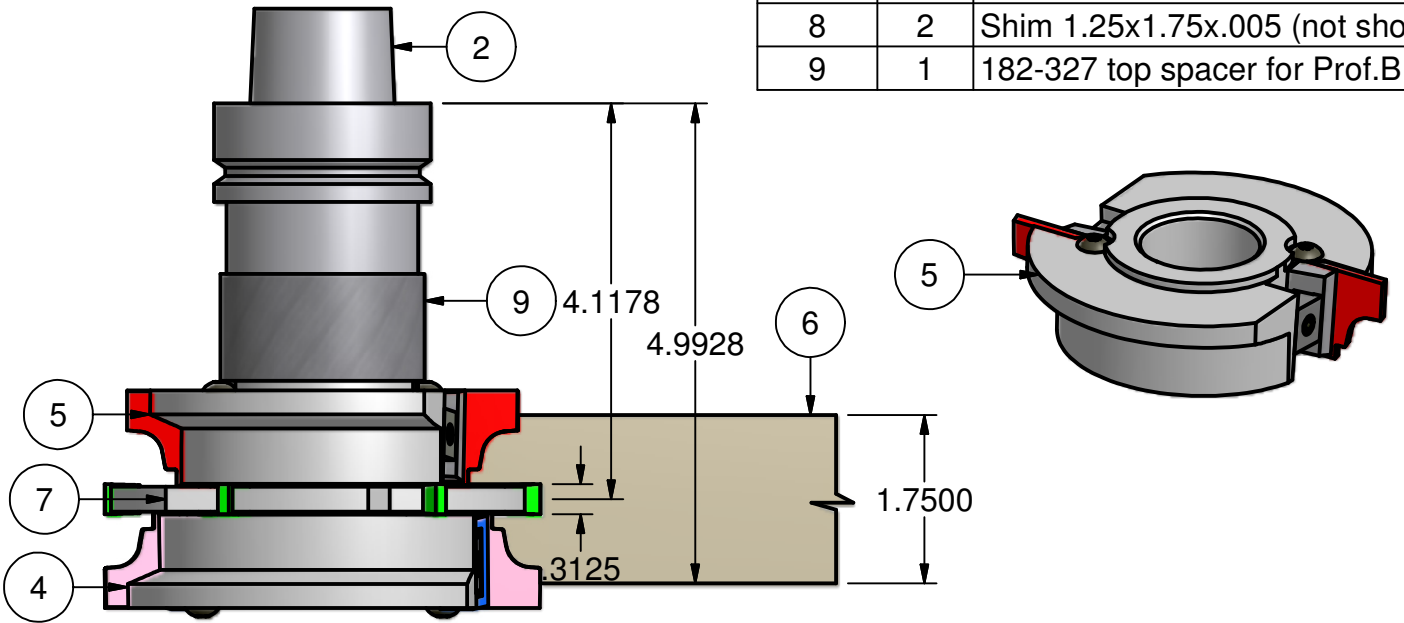

SCALE 1 / 2

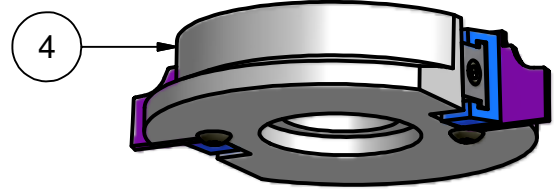
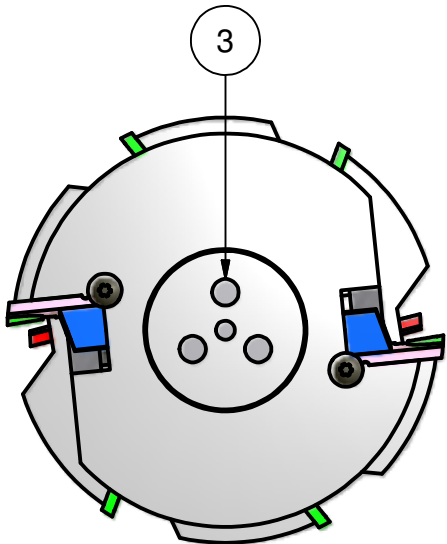
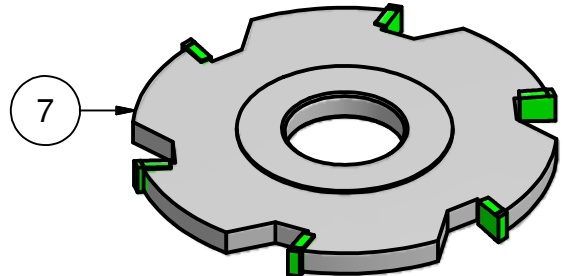

THIS DRAWING IS PROPERTY OF EW TOOLING, INC. AND MUST NOT BE USED IN ANY WAY DETRIMENTAL TO OUR INTERESTS

**E.W. TOOLING, INC.**  
Cutting tools for the woodworking industry

## PARTS LIST DRAWING

Originate: 12/09

Last edit: 12/14/09

EW P/N: 182-327

Tips: Carbide inserts

Cust P/N: Profile B for 1.75" wood

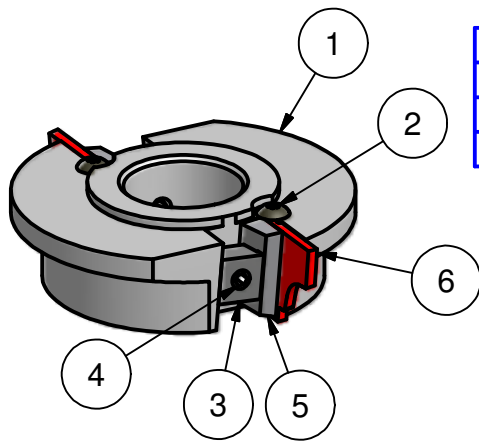

GEOMETRY	
2	Wing(s)
10°	Hook
Up 5°	Shear

SCALE 1 / 2

Parts List		
ITEM	QTY	PART NUMBER
1	1	182-327 A top CW body
2	2	3.5 mm X 6mm BH
3	2	.5 std clamp
4	2	.250-28 clamp screw
5	2	25x12 Wedge
6	2	182-340 top insert, prof.B

182-332 is used for  
1.75" wood

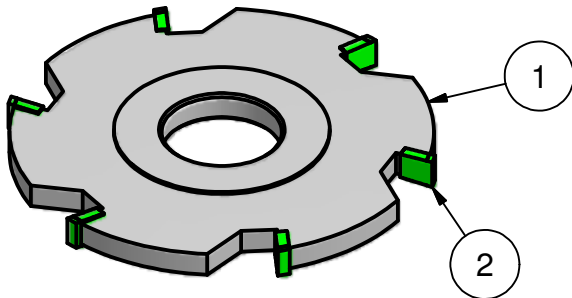

Parts List		
ITEM	QTY	PART NUMBER
1	1	182-332 body
2	6	182-332 brazed carbide tip

GEOMETRY	
2	Wing(s)
10°	Hook
Down 5°	Shear

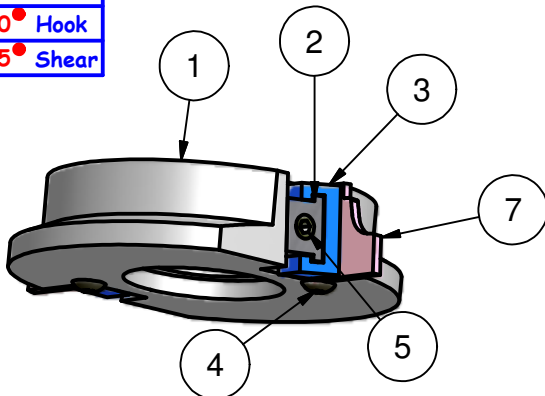

Parts List		
ITEM	QTY	PART NUMBER
1	1	182-327 E Bottom CW body
2	2	EW #1 clamp
3	2	EW #1 wedge
4	2	3.5 mm X 6mm BH
5	2	3125x24x1 clamp screw
7	2	182-341 btm insert, prof.B

THIS DRAWING IS PROPERTY OF EW TOOLING, INC. AND MUST NOT BE USED IN ANY WAY DETRIMENTAL TO OUR INTERESTS

## PARTS LIST DRAWING

**E.W. TOOLING, INC.**  
Cutting tools for the woodworking industry

Originate: 12/09

Last edit: 12/14/09

EW P/N: 182-327

Tips: Carbide inserts

Cust P/N: Profile B for 1.75" wood

<b>GEOMETRY</b>
2 Wing(s)
10° Hook
5° Shear

The minor diameter is 90mm

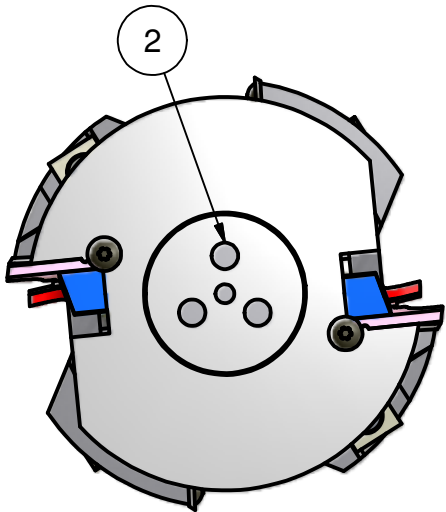
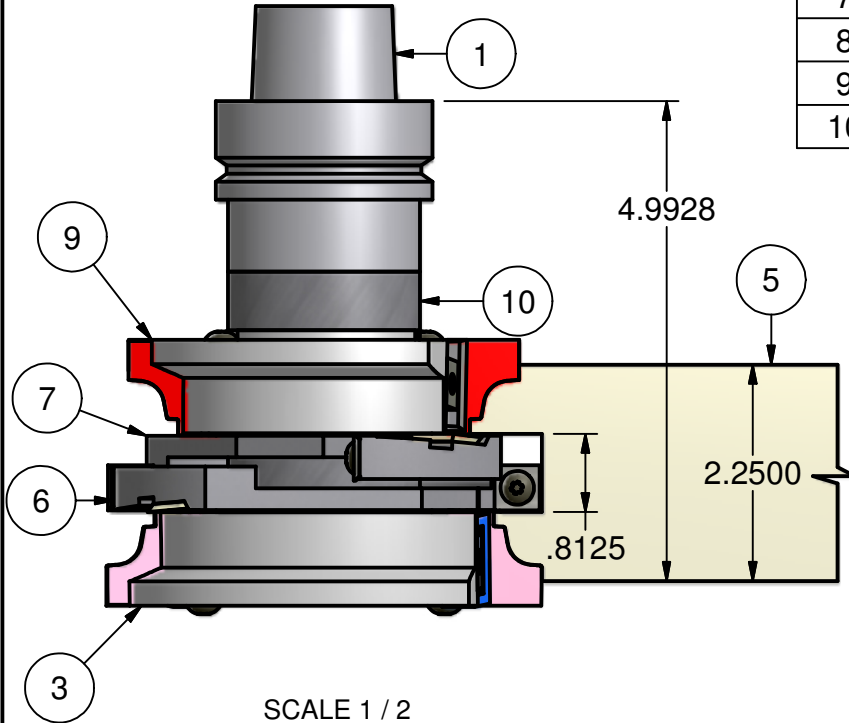

Parts List		
ITEM	QT	PART NUMBER
1	1	Lacey 1.250 toolholder
2	1	Lacey Toolholder Small Endcap
3	1	182-327 CW body E assembly
5	1	Stile B 2.25" wood
6	1	182-327 Groover body C assembly
7	1	182-327 Groover body B assembly
8	1	182-327 Groover spacer for 2.25 B
9	1	182-327 CW body A assembly
10	1	182-327 Top spacer for 2.25 B

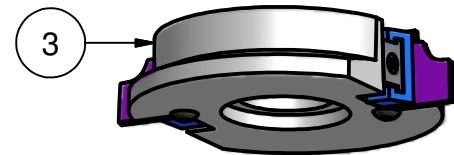
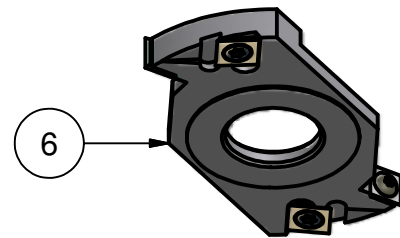
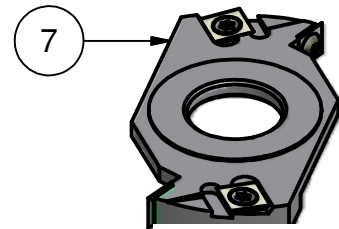
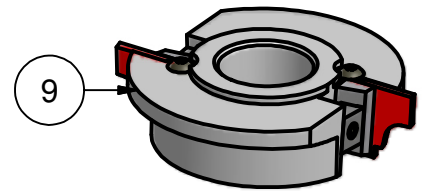

THIS DRAWING IS PROPERTY OF EW TOOLING, INC. AND MUST NOT BE USED IN ANY WAY DETRIMENTAL TO OUR INTERESTS

## PARTS LIST DRAWING

**E.W. TOOLING, INC.**  
Cutting tools for the woodworking industry

Originate: 12/09

Last edit: 12/14/09

EW P/N: 182-327

Tips: Carbide inserts

Cust P/N: Profile B for 2.25" wood

SCALE 1 / 2

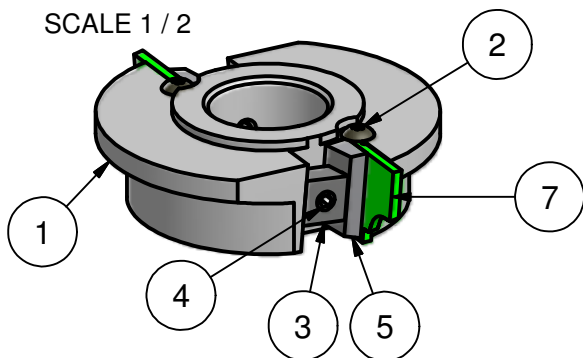

GEOMETRY	
2	Wing(s)
10	Hook
Up 5	Shear

Parts List		
ITEM	QTY	PART NUMBER
1	1	182-327 A top CW body
2	2	3.5 mm X 6mm BH
3	2	.5 std clamp
4	2	.250-28 clamp screw
5	2	25x12 Wedge
7	2	182-328 CW Insert

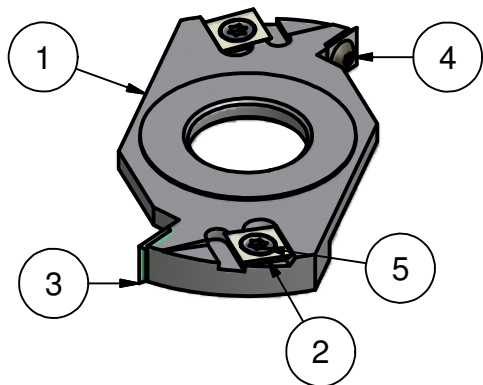

Parts List		
ITEM	QTY	PART NUMBER
1	1	182-327 B Groover CW body
2	2	14x14x2
3	2	12x12x1.5-35 deg
4	2	3.5 mm X 6mm BH
5	2	075-993 6x10-Flat Head Screw

The 2.25" wood uses B & C assemblies



Spacer runs between groovers

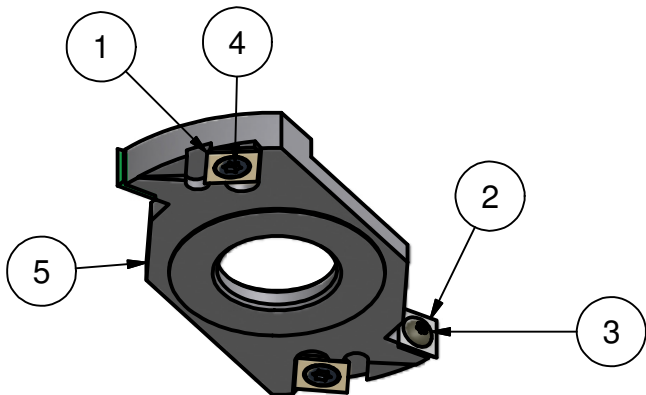
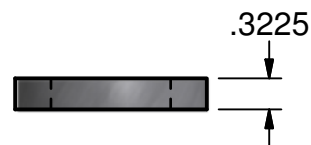

Parts List		
ITEM	QTY	PART NUMBER
1	2	14x14x2
2	2	12x12x1.5-35 deg
3	2	3.5 mm X 6mm BH
4	2	075-993 6x10-Flat Head Screw
5	1	182-327 C Groover CW body

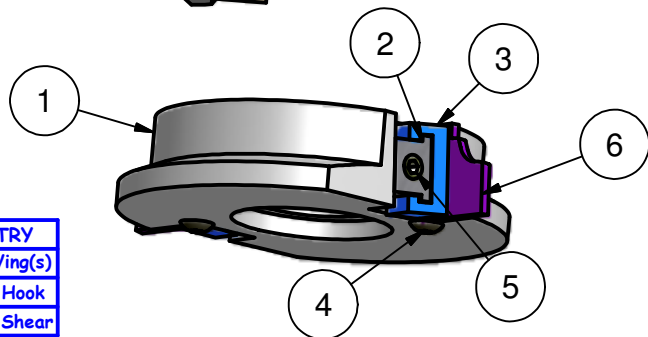

GEOMETRY	
2	Wing(s)
10	Hook
Down 5	Shear

Parts List		
ITEM	QTY	PART NUMBER
1	1	182-327 E Bottom CW body
2	2	EW #1 clamp
3	2	EW #1 wedge
4	2	3.5 mm X 6mm BH
5	2	3125x24x1 clamp screw
6	2	182-329 CW Insert

THIS DRAWING IS PROPERTY OF EW TOOLING, INC. AND MUST NOT BE USED IN ANY WAY DETRIMENTAL TO OUR INTERESTS

**E.W. TOOLING, INC.**  
Cutting tools for the woodworking industry

## PARTS LIST DRAWING

Originate: 12/09

Last edit: 12/14/09

EW P/N: 182-327

Tips: Carbide inserts

Cust P/N: Profile B for 2.25" wood

<b>GEOMETRY</b>	
2	Wing(s)
10°	Hook
5°	Shear

Setup for profile C 1.75" wood

The minor diameter is 90mm

1. Spacer .7365" thick
2. Body 327A with insert 342
3. Groover body 327 B
4. Spacer .1975 thick
5. Groover body 327 C
6. Body 327E with insert 343
7. End cap

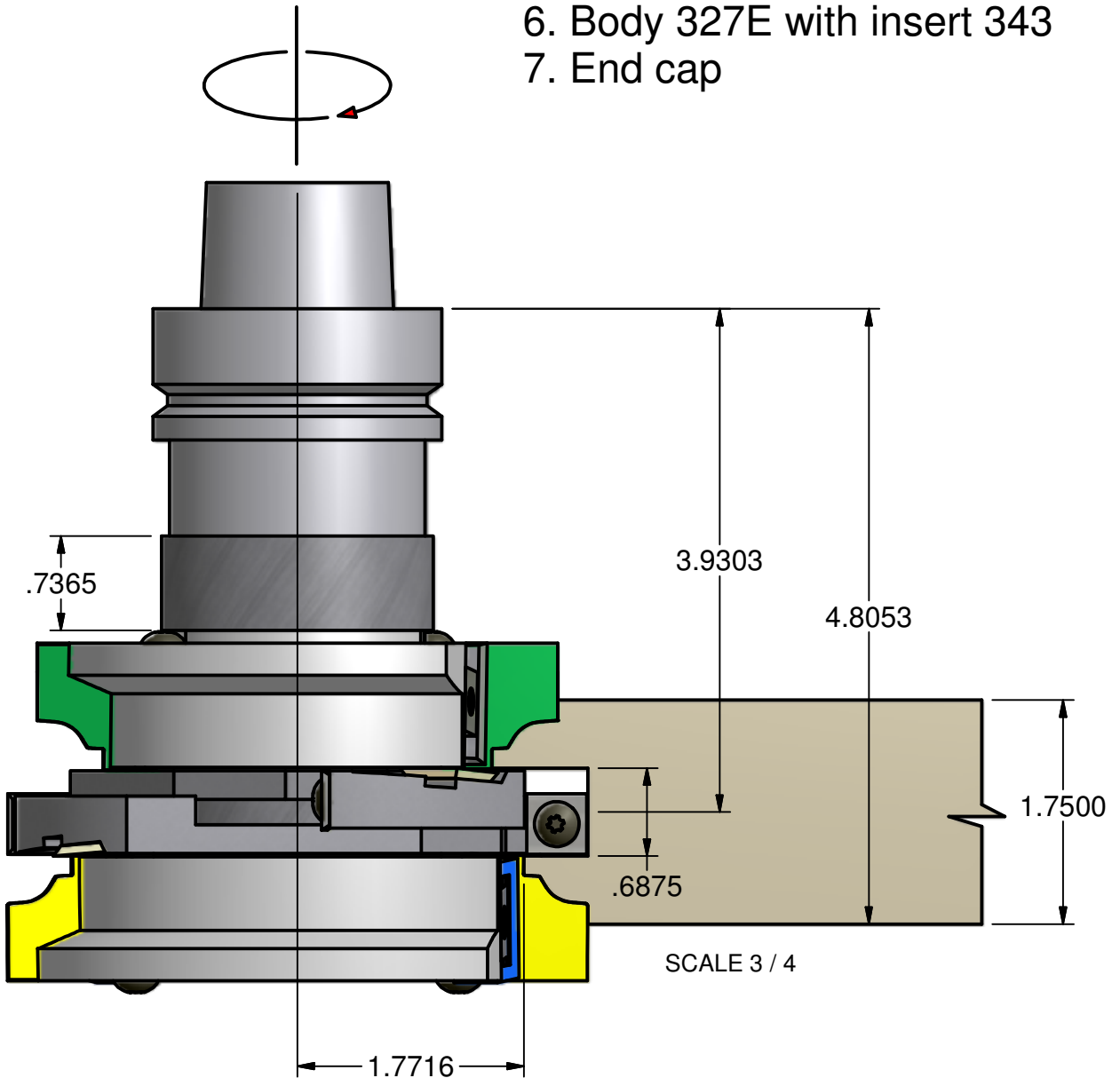

THIS DRAWING IS PROPERTY OF EW TOOLING, INC. AND MUST NOT BE USED IN ANY WAY DETRIMENTAL TO OUR INTERESTS

## PARTS LIST DRAWING

**E.W. TOOLING, INC.**  
Cutting tools for the woodworking industry

Originate: 12/09

Last edit: 12/14/09

EW P/N: 182-327

Tips: Carbide inserts

Cust P/N: Profile C for 1.75" wood

<b>GEOMETRY</b>
2 Wing(s)
10° Hook
5° Shear

The minor diameter is 90mm

Parts List		
ITEM	QT	PART NUMBER
2	1	Lacey 1.250 toolholder
3	1	Lacey Toolholder Small Endcap
4	1	182-327 CW body E assembly
6	1	Stile C 1.75
7	1	182-327 Groover body C assembly
8	1	182-327 Groover body B assembly
9	1	182-327 Groover spacer for prof. C
10	1	182-327 CW body A assembly
11	1	182-327 top spacer for Profile C

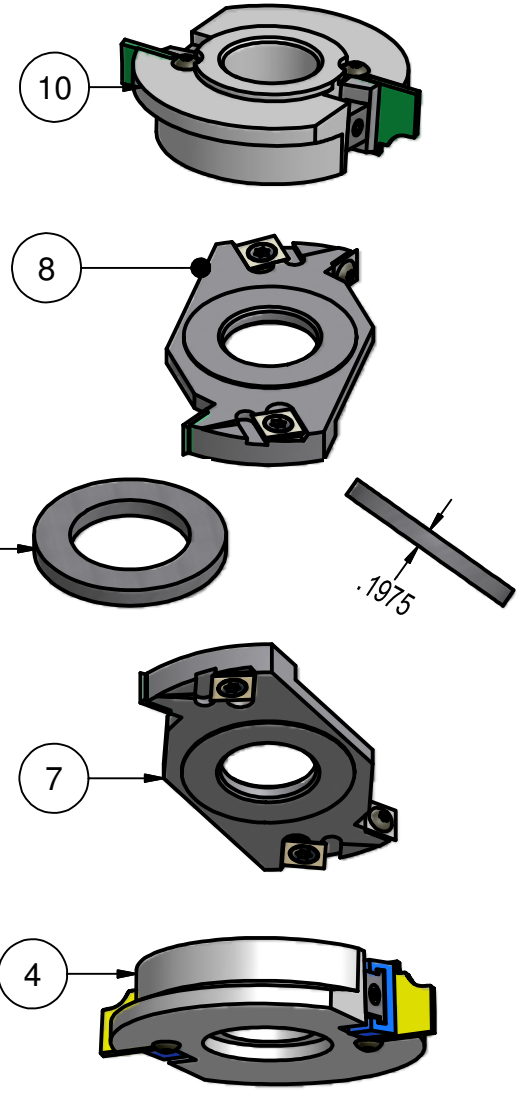
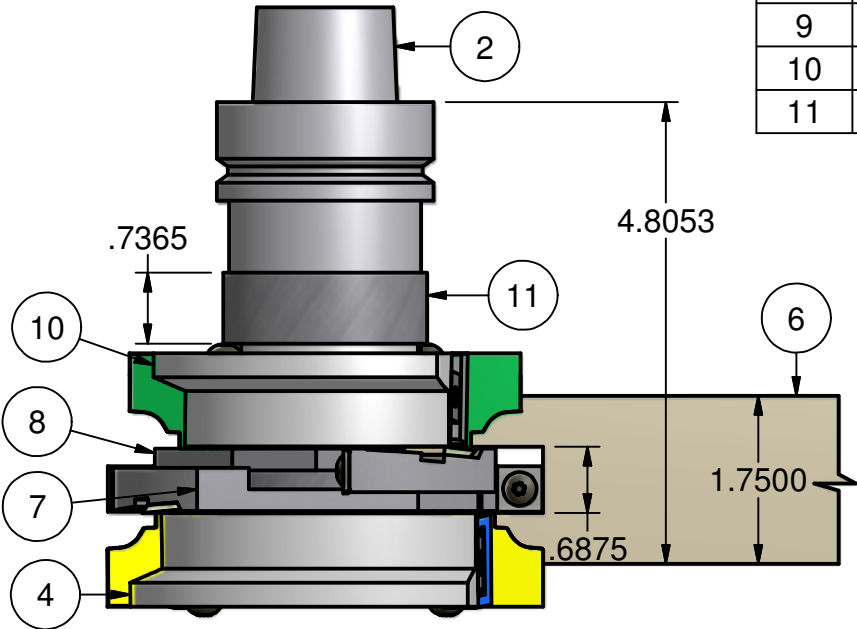

SCALE 1 / 2

9 -Spacer runs between B & C

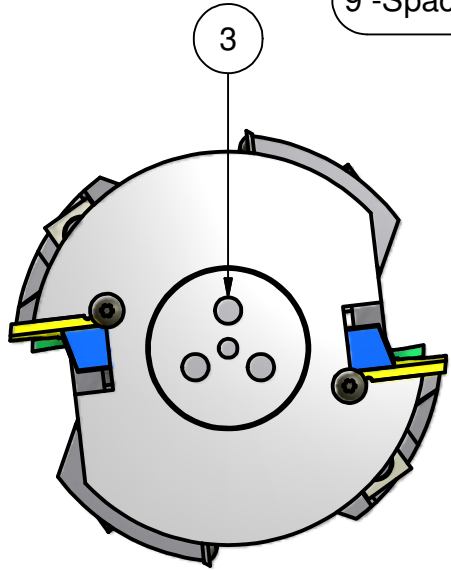

THIS DRAWING IS PROPERTY OF EW TOOLING, INC. AND MUST NOT BE USED IN ANY WAY DETRIMENTAL TO OUR INTERESTS

## PARTS LIST DRAWING

**E.W. TOOLING, INC.**  
Cutting tools for the woodworking industry

Originate: 12/09

Last edit: 12/14/09

EW P/N: 182-327

Tips: Carbide inserts

Cust P/N: Profile C for 1.75" wood



<b>GEOMETRY</b>
2 Wing(s)
10° Hook
5° Shear

Setup for profile D 2.25" wood

The minor diameter is 90mm

1. Spacer .4865" thick
2. Body 327A with insert 345
3. Groover body 327B
4. Spacer \* .4475 thick
5. Groover body 327C
6. Body 327E with insert 346
7. End cap

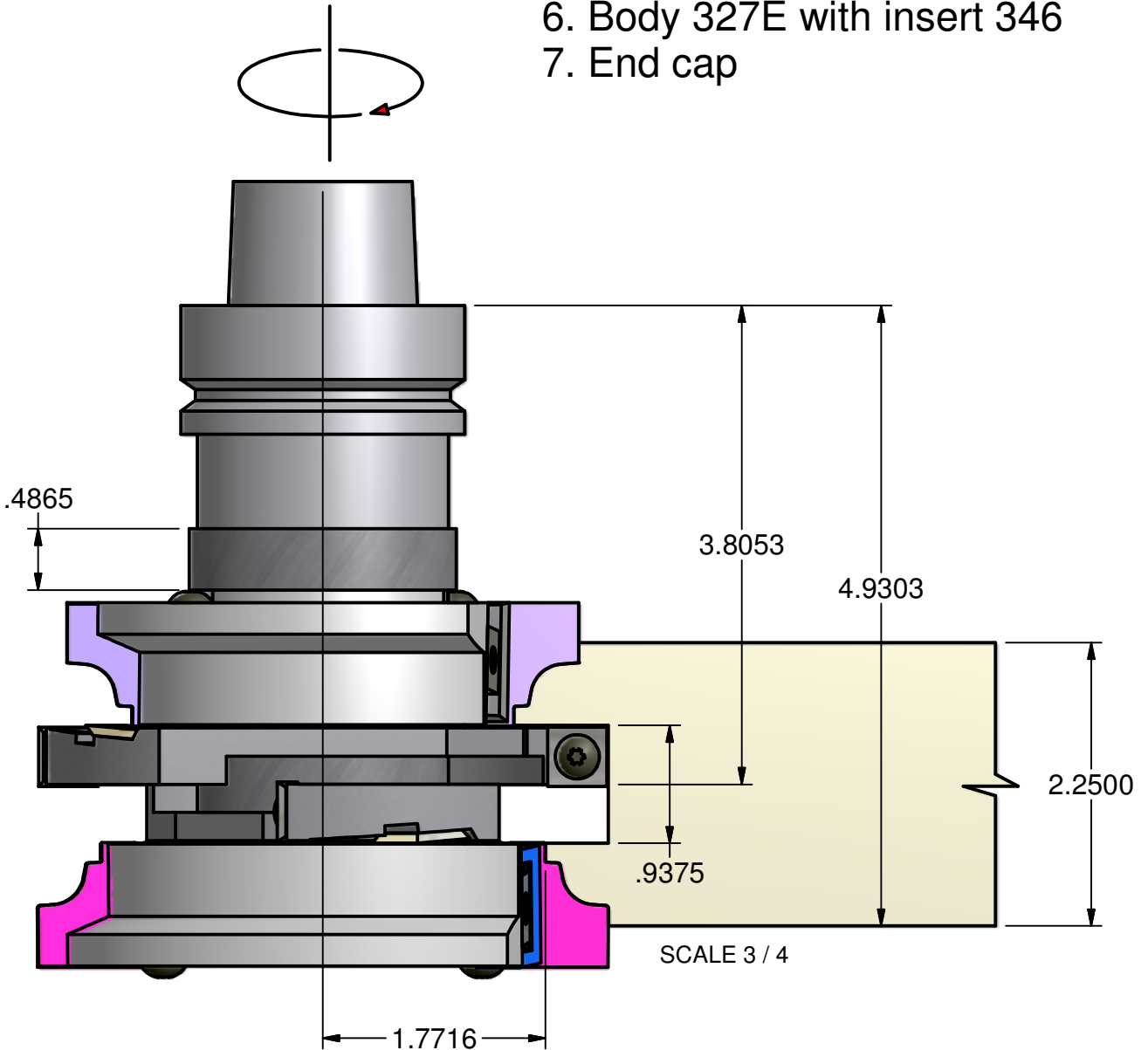

THIS DRAWING IS PROPERTY OF EW TOOLING, INC. AND MUST NOT BE USED IN ANY WAY DETRIMENTAL TO OUR INTERESTS

## PARTS LIST DRAWING

**E.W. TOOLING, INC.**  
Cutting tools for the woodworking industry

Originate: 12/09

Last edit: 12/14/09

EW P/N: 182-327

Tips: Carbide inserts

Cust P/N: Profile D for 2.25" wood

GEOMETRY
2 Wing(s)
10° Hook
5° Shear

The minor diameter is 90mm

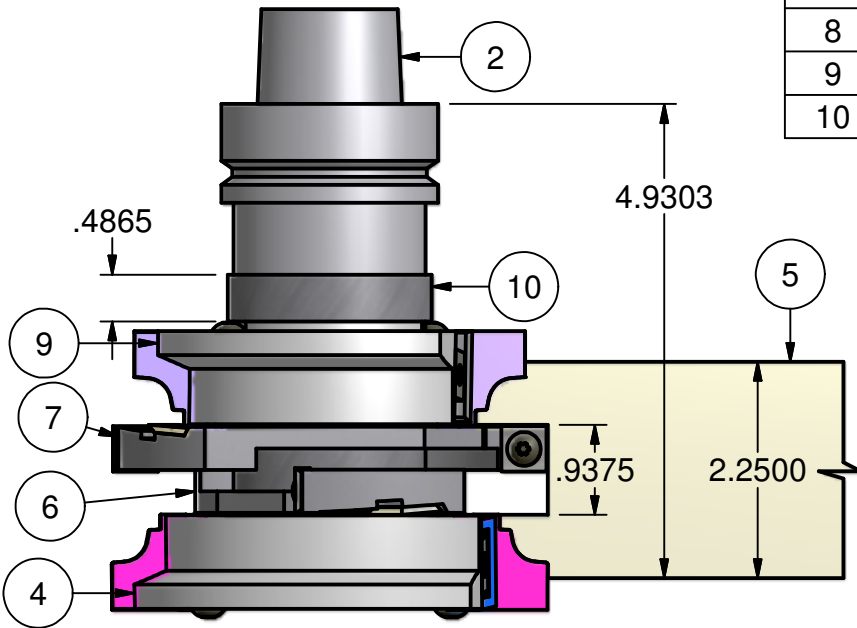

SCALE 1 / 2

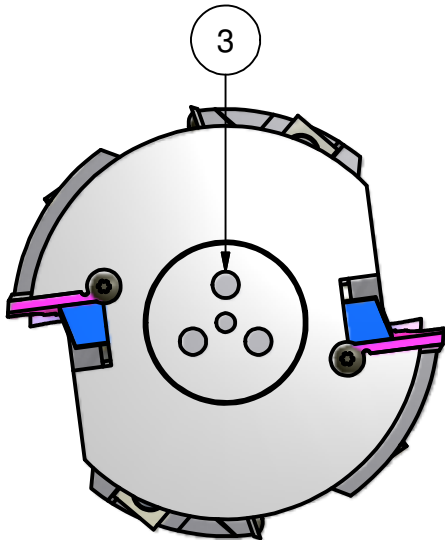

8 - between groovers

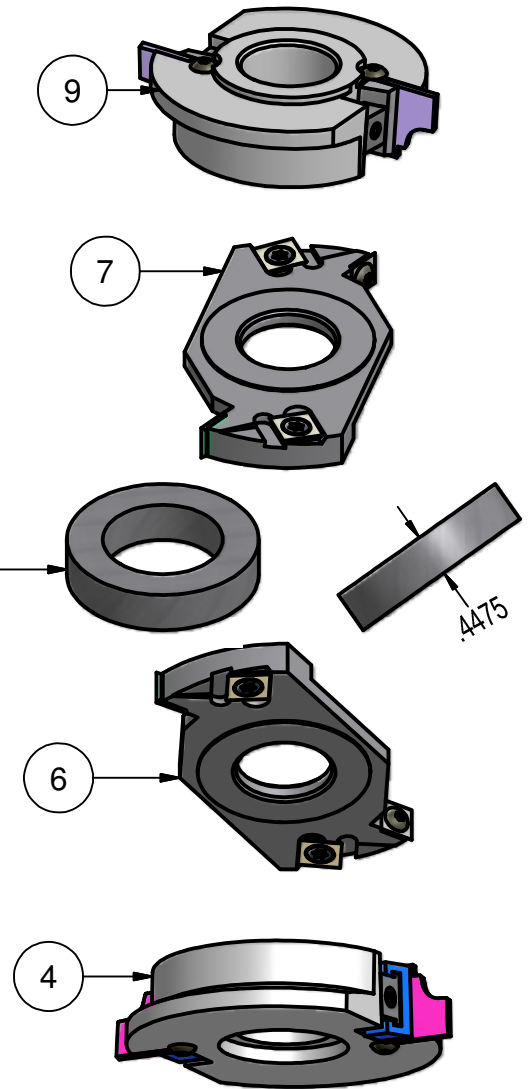

Parts List

ITEM	QT	PART NUMBER
2	1	Lacey 1.250 toolholder
3	1	Lacey Toolholder Small Endcap
4	1	182-327 CW body E assembly
5	1	Profile D 2.25" wood
6	1	182-327 Groover body C assembly
7	1	182-327 Groover body B assembly
8	1	182-327 Groover spacer for prof. D
9	1	182-327 CW body A assembly
10	1	182-327 top spacer for Prof.D

THIS DRAWING IS PROPERTY OF EW TOOLING, INC. AND MUST NOT BE USED IN ANY WAY DETRIMENTAL TO OUR INTERESTS

PARTS LIST DRAWING

**E.W. TOOLING, INC.**  
Cutting tools for the woodworking industry

Originate: 12/09

Last edit: 12/14/09

EW P/N: 182-327

Tips: Carbide inserts

Cust P/N: Profile D for 2.25" wood

SCALE 1 / 2

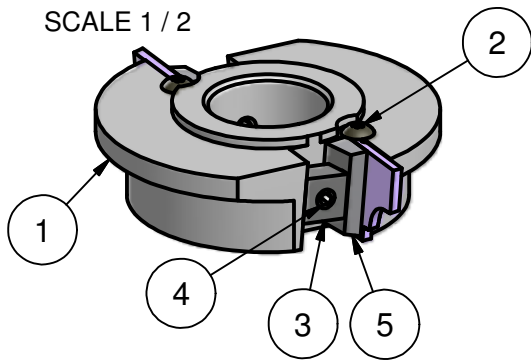

GEOMETRY	
2	Wing(s)
10	Hook
Up 5	Shear

Parts List		
ITEM	QTY	PART NUMBER
1	1	182-327 A top CW body
2	2	3.5 mm X 6mm BH
3	2	.5 std clamp
4	2	.250-28 clamp screw
5	2	25x12 Wedge
9	2	182-345 insert,body A prof.D

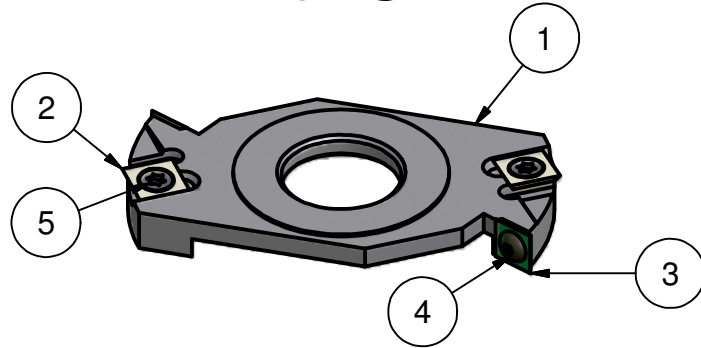

Parts List		
ITEM	QT	PART NUMBER
1	1	182-327 B Groover CW body
2	2	14x14x2
3	2	12x12x1.5-35 deg
4	2	3.5 mm X 6mm BH
5	2	075-993 6x10-Flat Head Screw

The 2.25" wood uses B & C assemblies

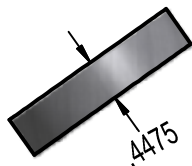

8 - between groovers

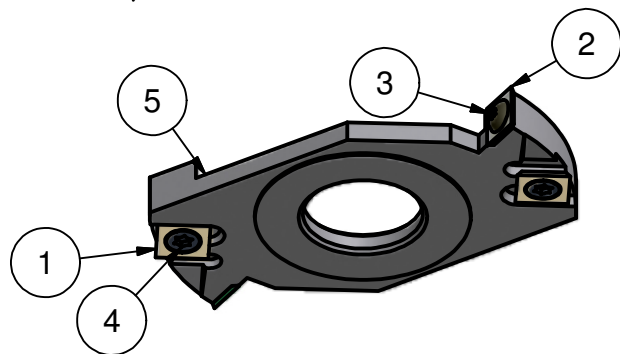

Parts List		
ITEM	QT	PART NUMBER
1	2	14x14x2
2	2	12x12x1.5-35 deg
3	2	3.5 mm X 6mm BH
4	2	075-993 6x10-Flat Head Screw
5	1	182-327 C Groover CW body

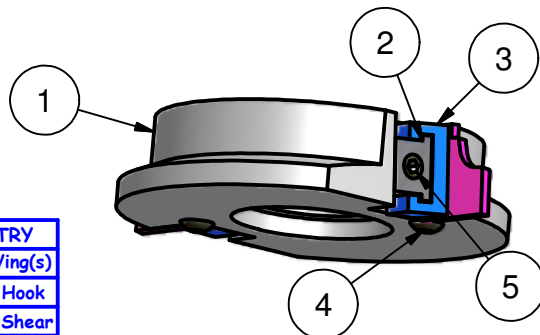

GEOMETRY	
2	Wing(s)
10	Hook
Down 5	Shear

Parts List		
ITEM	QTY	PART NUMBER
1	1	182-327 E Bottom CW body
2	2	EW #1 clamp
3	2	EW #1 wedge
4	2	3.5 mm X 6mm BH
5	2	3125x24x1 clamp screw
9	2	182-346 insert,body E prof.D

THIS DRAWING IS PROPERTY OF EW TOOLING, INC. AND MUST NOT BE USED IN ANY WAY DETRIMENTAL TO OUR INTERESTS

**E.W. TOOLING, INC.**  
Cutting tools for the woodworking industry

## PARTS LIST DRAWING

Originate: 12/09

Last edit: 12/14/09

EW P/N: 182-327

Tips: Carbide inserts

Cust P/N: Profile D for 2.25" wood

<b>GEOMETRY</b>	
2	Wing(s)
10°	Hook
5°	Shear

Setup for profile E 1.375" wood

1. Spacer 1.1165" thick
2. Body 327A with insert 328
3. Brazed groover body 332
4. Body 327E with insert 329
5. End cap

The minor diameter is 90mm

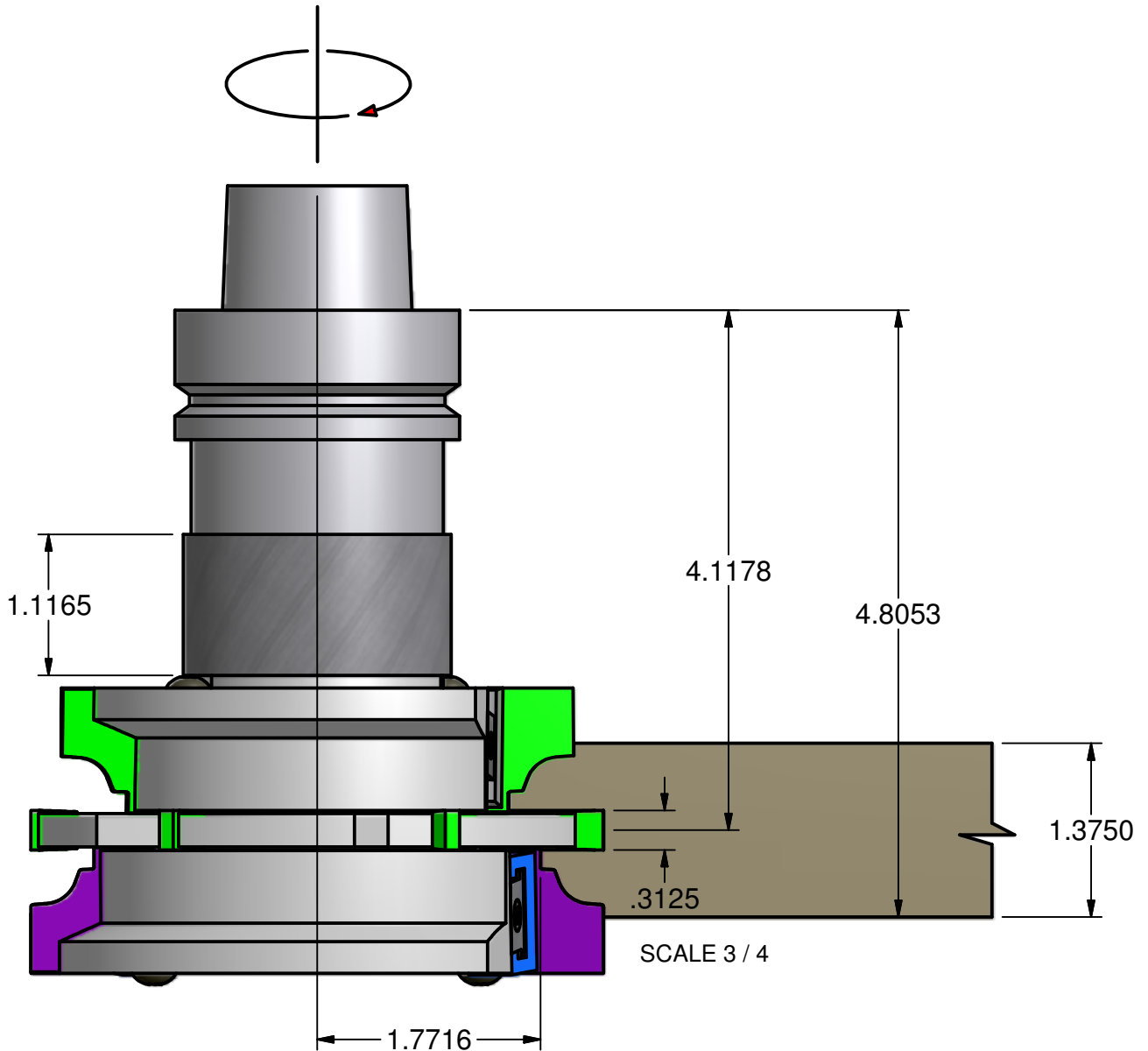

THIS DRAWING IS PROPERTY OF EW TOOLING, INC. AND MUST NOT BE USED IN ANY WAY DETRIMENTAL TO OUR INTERESTS

## PARTS LIST DRAWING

**E.W. TOOLING, INC.**  
Cutting tools for the woodworking industry

Originate: 12/09

Last edit: 12/14/09

EW P/N: 182-327

Tips: Carbide inserts

Cust P/N: Profile E for 1.375" wood

GEOMETRY	
2	Wing(s)
10°	Hook
5°	Shear

The minor diameter is 90mm

## Setup for profile E 1.75" wood

1. Spacer .8615" thick
2. Body 327A with insert 328
3. Groover body 327B
4. Spacer .0730 thick
5. Groover body 327C
6. Body 327E with insert 329
7. End cap

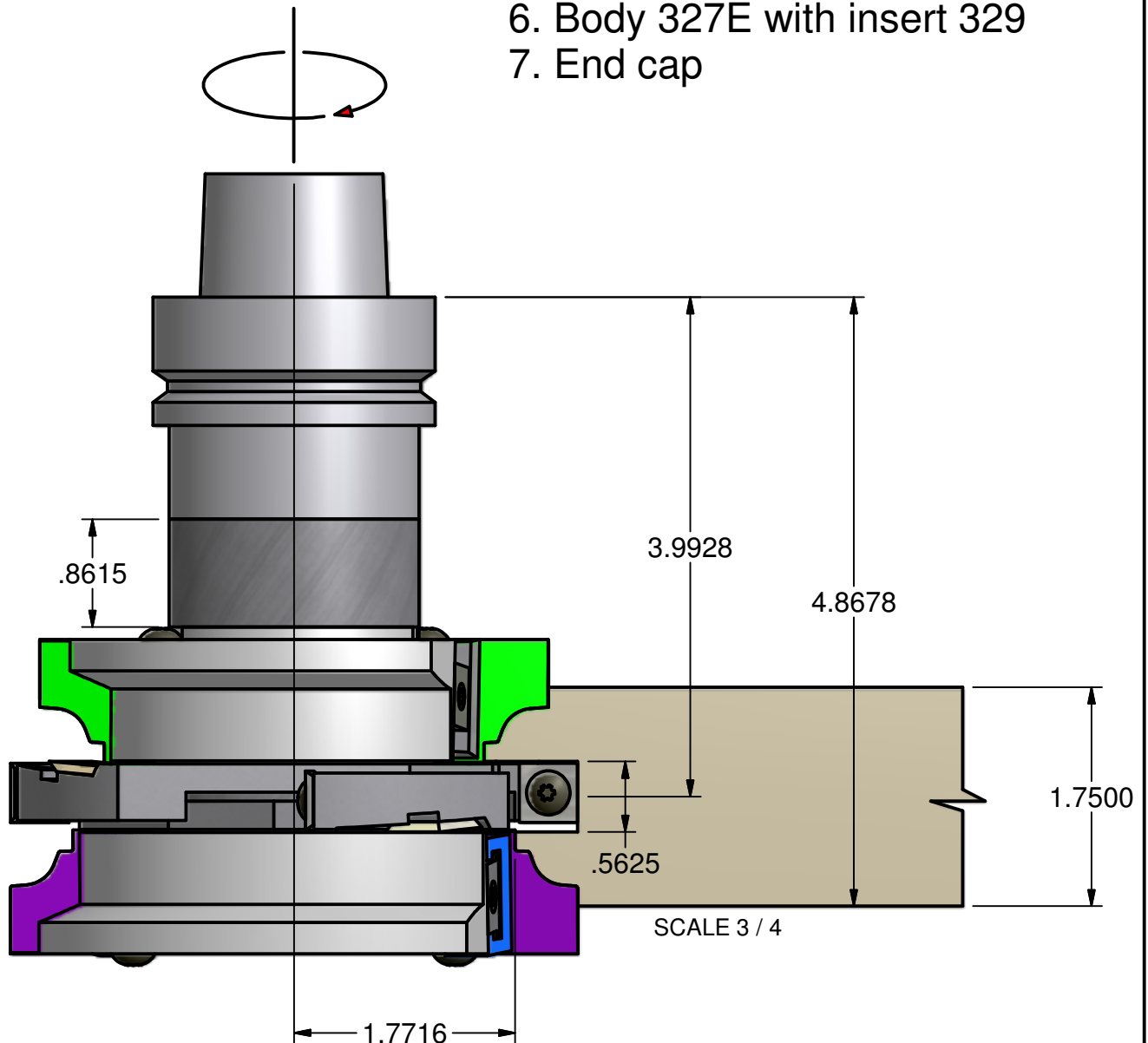

THIS DRAWING IS PROPERTY OF EW TOOLING, INC. AND MUST NOT BE USED IN ANY WAY DETRIMENTAL TO OUR INTERESTS

**E.W. TOOLING, INC.**  
Cutting tools for the woodworking industry

## PARTS LIST DRAWING

Originate: 12/09

Last edit: 12/14/09

EW P/N: 182-327

Tips: Carbide inserts

Cust P/N: Profile E for 1.75" wood

<b>GEOMETRY</b>	
2	Wing(s)
10°	Hook
5°	Shear

Setup for profile E 2.25" wood

1. Spacer .3615" thick
2. Body 327A with insert 328
3. Groover body 327 B
4. Groover body 327 D
5. Groover body 327 C
6. Body 327E with insert 329
7. End cap

The minor diameter is 90mm

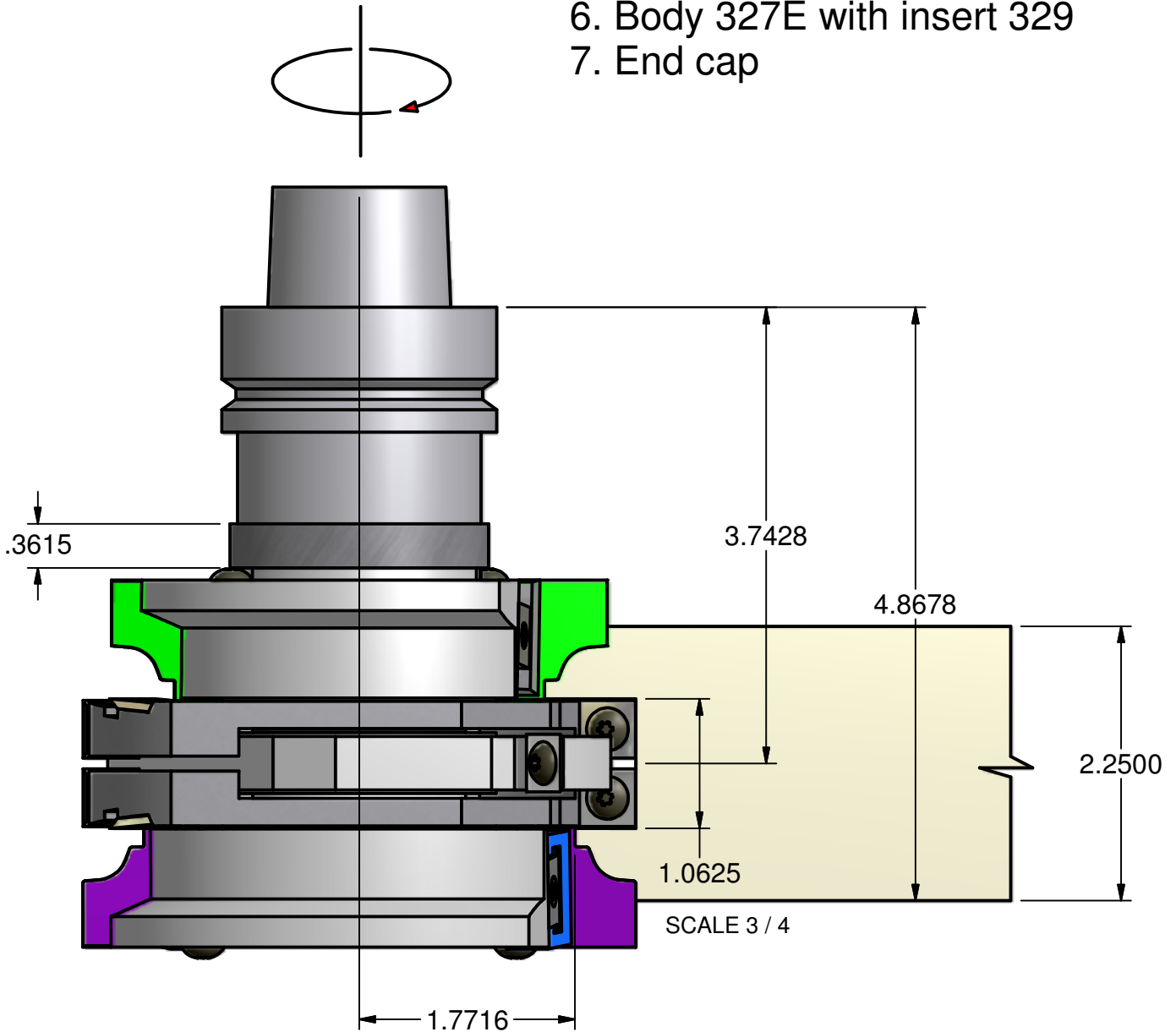

THIS DRAWING IS PROPERTY OF EW TOOLING, INC. AND MUST NOT BE USED IN ANY WAY DETRIMENTAL TO OUR INTERESTS

## PARTS LIST DRAWING

**E.W. TOOLING, INC.**  
Cutting tools for the woodworking industry

Originate: 12/09

Last edit: 12/14/09

EW P/N: 182-327

Tips: Carbide inserts

Cust P/N: Profile E for 2.25" wood