

GEOMETRY
2 Wing(s)
10° Hook
5° Shear

Setup for profile A 1.375" wood

1. Spacer 1.175" thick
2. Body 326A with insert 330
3. Brazed groover body 334
4. Body 326E with insert 331
5. End cap

The minor diameter is 90mm

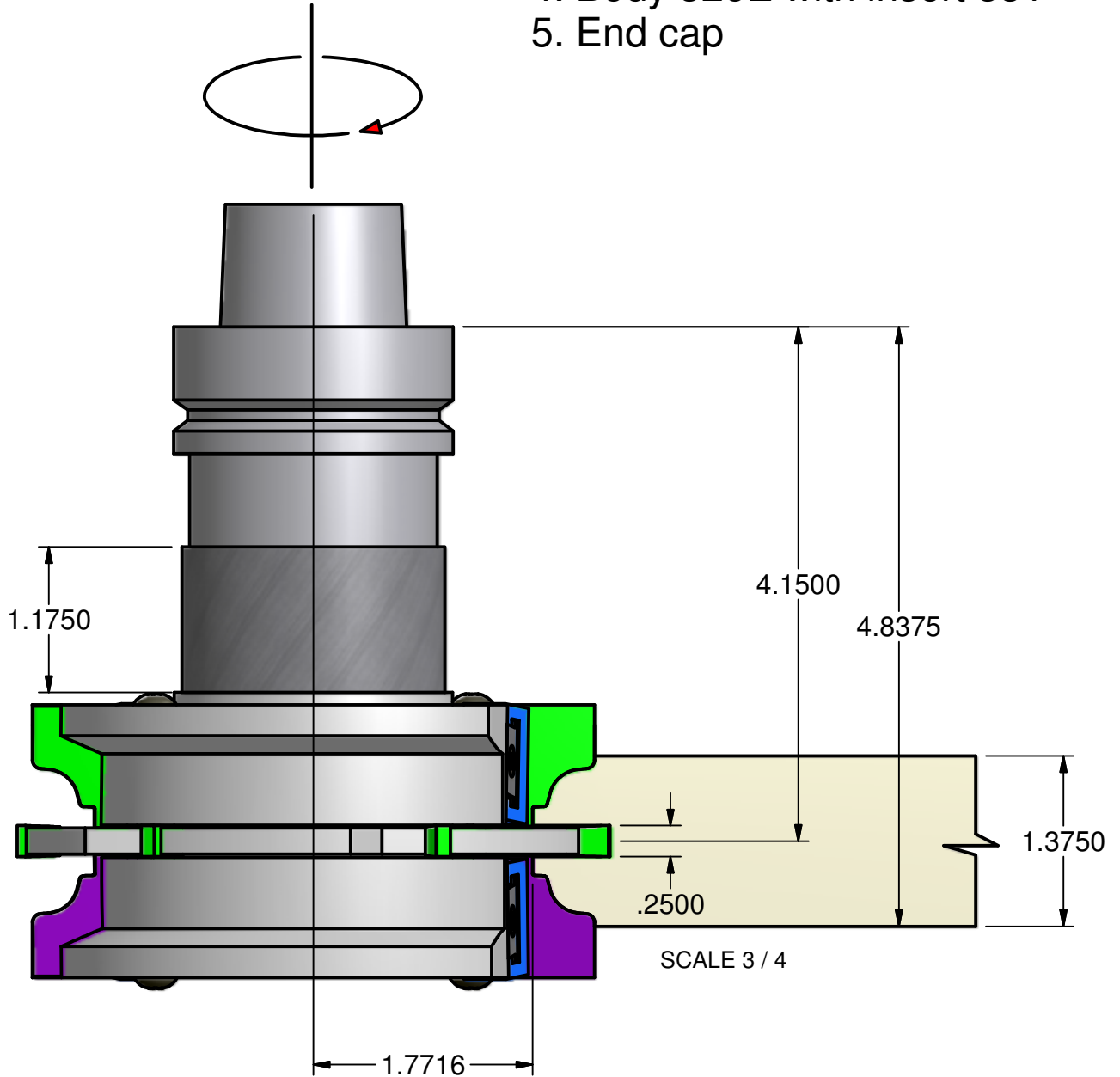

THIS DRAWING IS PROPERTY OF EW TOOLING, INC. AND MUST NOT BE USED IN ANY WAY DETRIMENTAL TO OUR INTERESTS

PARTS LIST DRAWING

E.W. TOOLING, INC.
Cutting tools for the woodworking industry

Originate: 12/09

Last edit: 12/14/09

EW P/N: 182-326

Tips: Carbide inserts

Cust P/N: Profile A 1.375" wood

GEOMETRY
2 Wing(s)
10° Hook
5° Shear

The minor diameter is 90mm

Setup for profile A 1.75" wood

1. Spacer .925" thick
2. Body 326A with insert 330
3. Groover body 326B
4. 1.25 x .010 shim
5. Groover body 326C
6. Body 326E with insert 331
7. End cap

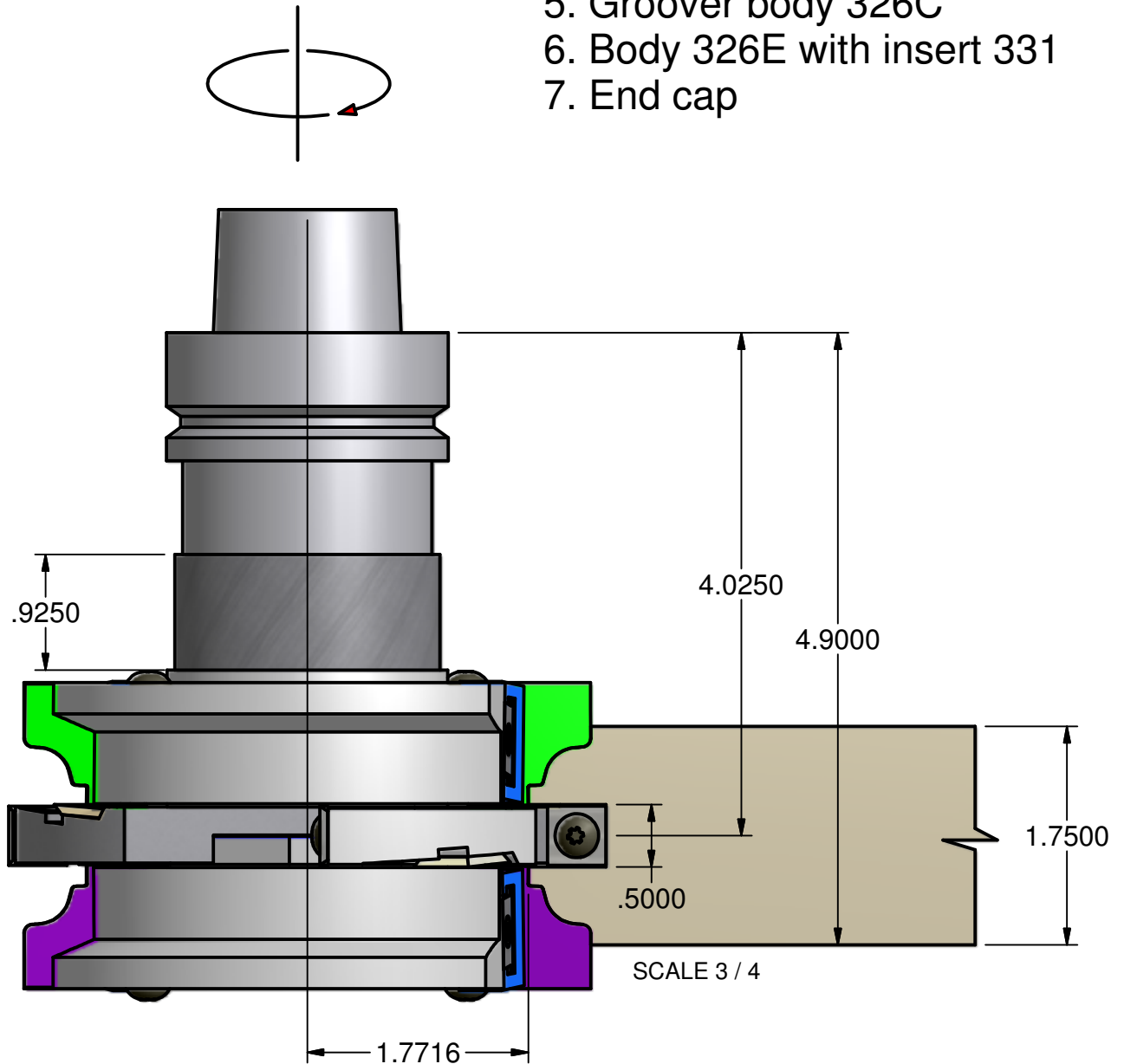

THIS DRAWING IS PROPERTY OF EW TOOLING, INC. AND MUST NOT BE USED IN ANY WAY DETRIMENTAL TO OUR INTERESTS

PARTS LIST DRAWING

E.W. TOOLING, INC.
Cutting tools for the woodworking industry

Originate: 12/09

Last edit: 12/14/09

EW P/N: 182-326

Tips: Carbide inserts

Cust P/N: Profile A 1.75" wood

GEOMETRY	
2	Wing(s)
10°	Hook
5°	Shear

The minor diameter is 90mm

Setup for profile A 2.25" wood

1. Spacer .424" thick
2. Body 326A with insert 330
3. Groover body 326B
4. 1.25 x .010 shim
5. Groover body 326D
6. Groover body 326C
7. Body 326E with insert 331
8. End cap

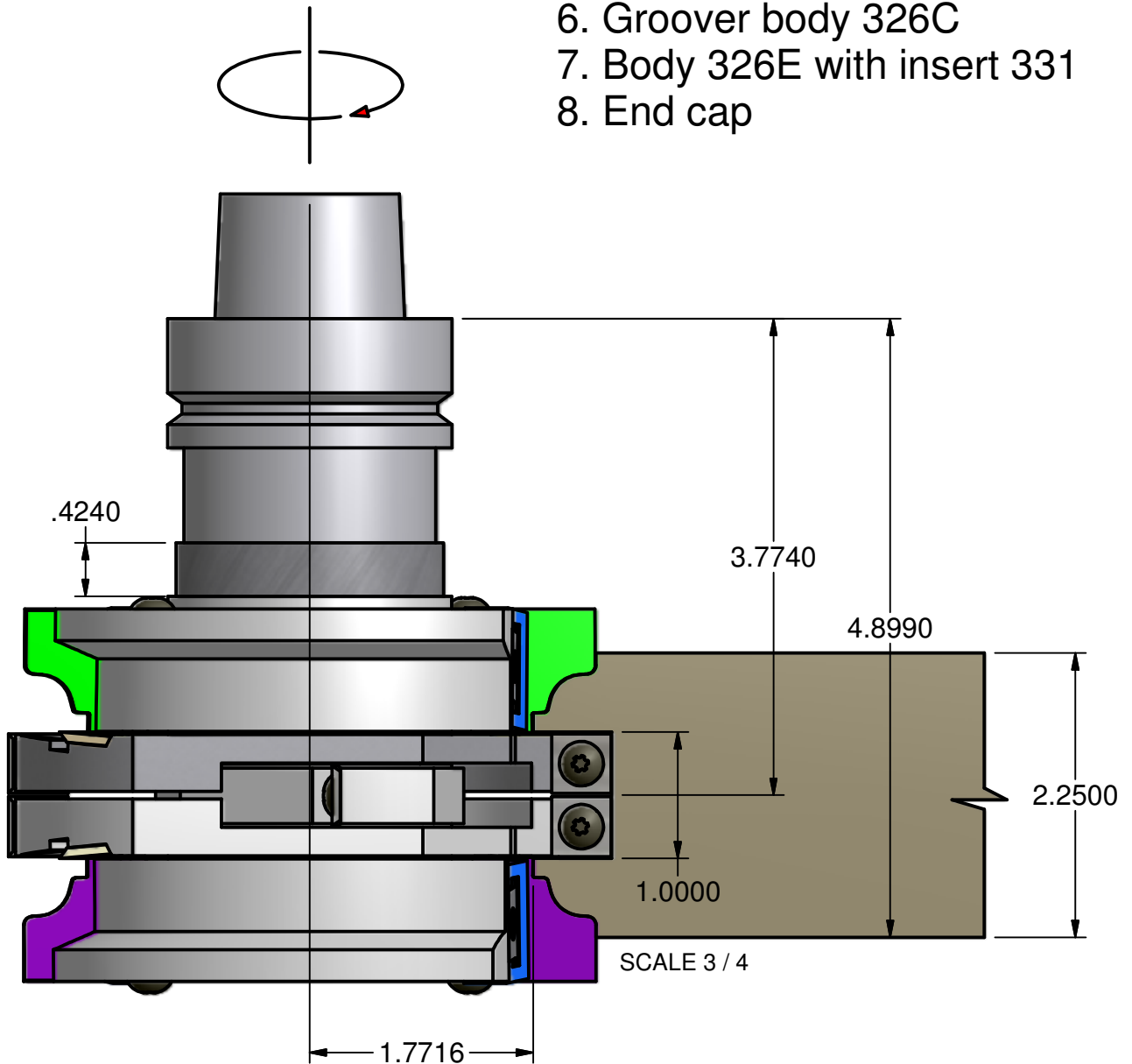

THIS DRAWING IS PROPERTY OF EW TOOLING, INC. AND MUST NOT BE USED IN ANY WAY DETRIMENTAL TO OUR INTERESTS

PARTS LIST DRAWING

E.W. TOOLING, INC.
Cutting tools for the woodworking industry

Originate: 12/09

Last edit: 12/14/09

EW P/N: 182-326

Tips: Carbide inserts

Cust P/N: Profile A 2.25" wood

GEOMETRY
2 Wing(s)
10° Hook
5° Shear

The minor diameter is 90mm

Parts List		
ITEM	QTY	PART NUMBER
2	1	Lacey 1.250 toolholder
3	1	Lacey Toolholder Small Endcap
4	1	Lacey Stile 1.375
5	1	182-334 CW assembly
6	1	182-326 CW body A assembly
7	1	182-326 (1.175) spacer for 1.375 wood
8	1	182-326 CW body E assembly

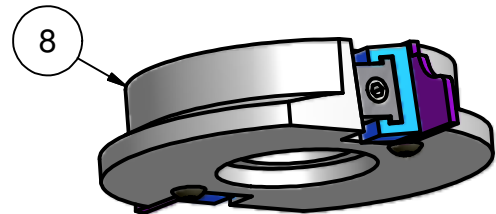
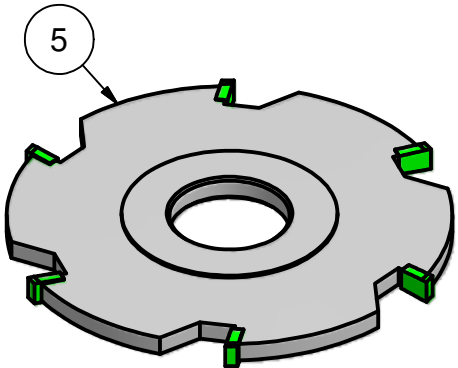
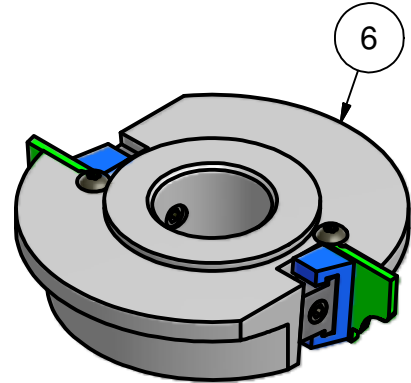
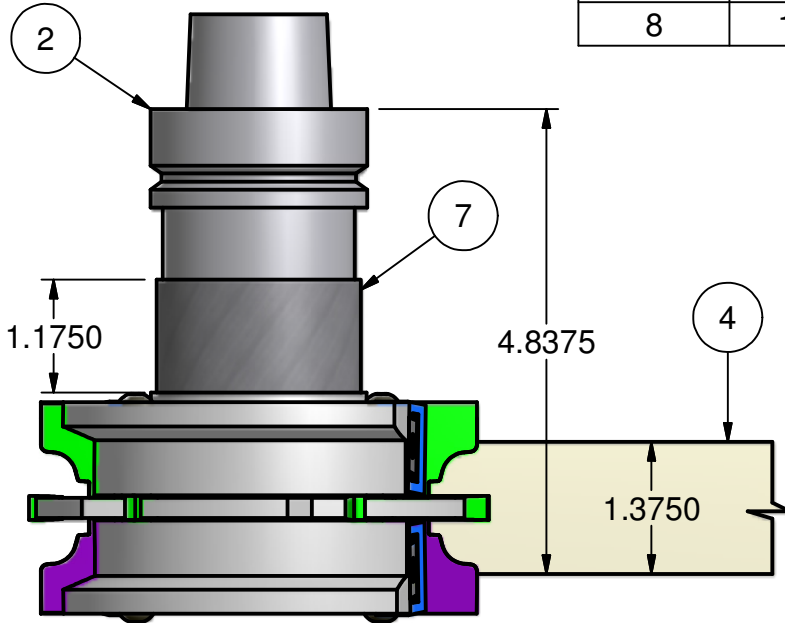

SCALE 1 / 2

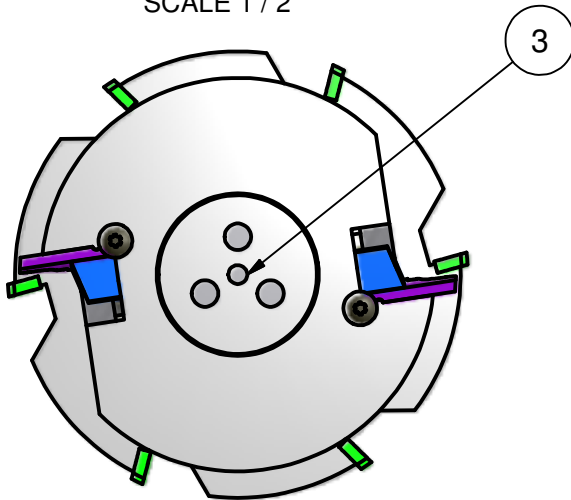

THIS DRAWING IS PROPERTY OF EW TOOLING, INC. AND MUST NOT BE USED IN ANY WAY DETRIMENTAL TO OUR INTERESTS

PARTS LIST DRAWING

E.W. TOOLING, INC.
Cutting tools for the woodworking industry

Originate: 12/09

Last edit: 12/14/09

EW P/N: 182-326

Tips: Carbide inserts

Cust P/N: Profile A 1.375" wood

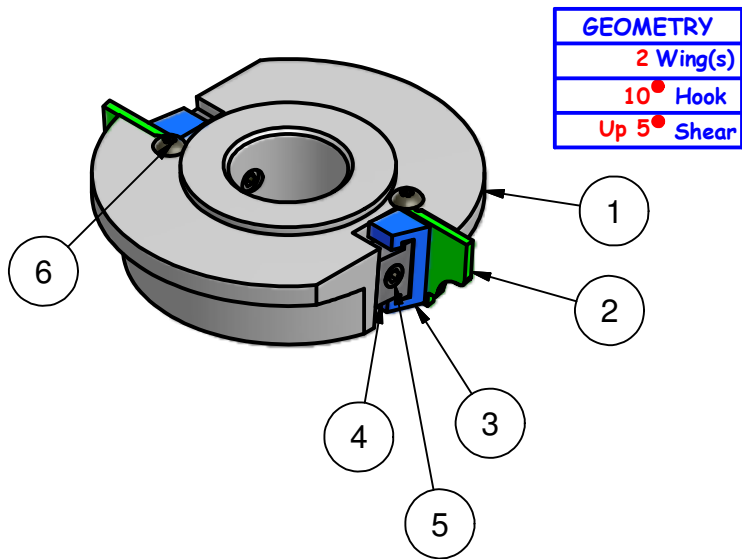

Parts List		
ITEM	QTY	PART NUMBER
1	1	182-326 A top body CW
2	2	182-330 Insert CW
3	2	EW #1 wedge
4	2	EW #1 clamp
5	2	3125x24x1 clamp screw
6	2	3.5 mm X 6mm BH

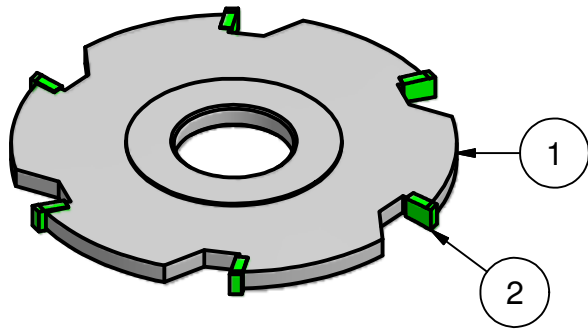

182-334 is used only
for 1.375" wood

Parts List		
ITEM	QTY	PART NUMBER
1	1	182-334 body
2	6	182-334 Brazed tip

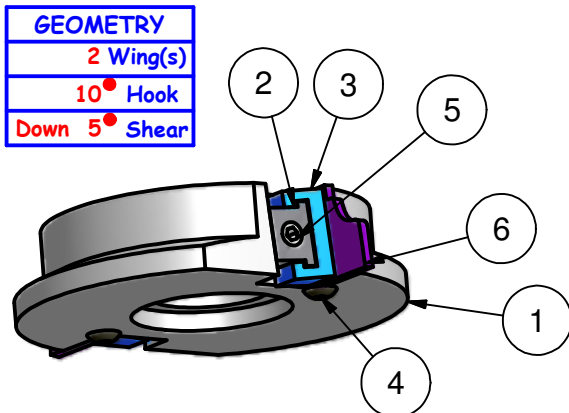

Parts List		
ITEM	QTY	PART NUMBER
1	1	182-326 E Bottom body CW
2	2	EW #1 clamp
3	2	EW #1 wedge
4	2	3.5 mm X 6mm BH
5	2	3125x24x1 clamp screw
6	2	182-331 Insert CW

THIS DRAWING IS PROPERTY OF EW TOOLING, INC. AND MUST NOT BE USED IN ANY WAY DETRIMENTAL TO OUR INTERESTS

E.W. TOOLING, INC.
Cutting tools for the woodworking industry

PARTS LIST DRAWING

Originate: 12/09

Last edit: 12/14/09

EW P/N: 182-326

Tips: Carbide inserts

Cust P/N: Profile A 1.375" wood

GEOMETRY
2 Wing(s)
10° Hook
5° Shear

The minor diameter is 90mm

Parts List		
ITEM	QTY	PART NUMBER
1	1	Lacey Stile 1.75" Bead
14	1	Lacey 1.250 toolholder
16	1	Lacey Toolholder Small Endcap
17	1	182-326 1.750 spacer
18	1	182-326 CW body E assembly
19	1	182-326 B Groover body assembly
20	1	182-326 C Groover body assembly
21	1	Shim 1.25x1.75x.010
22	1	182-326 CW body A assembly

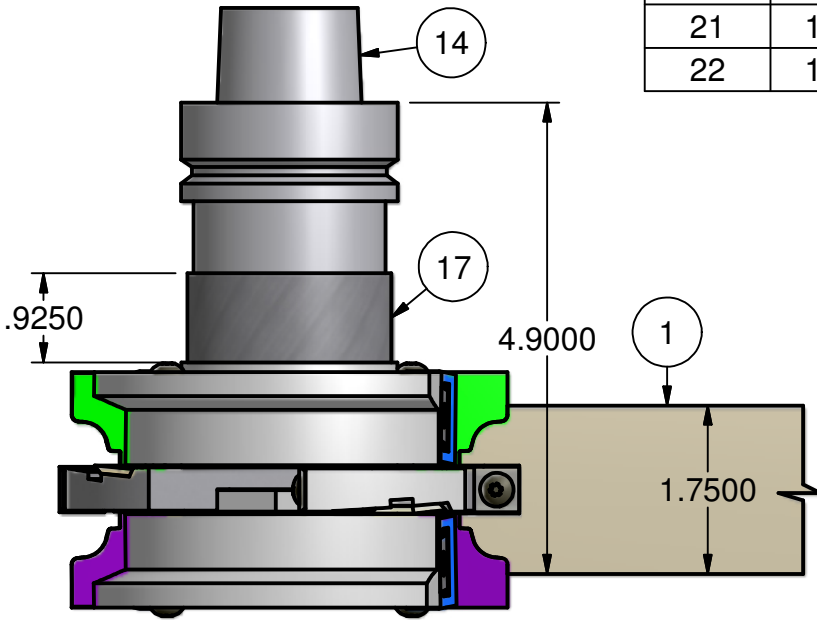

SCALE 1 / 2

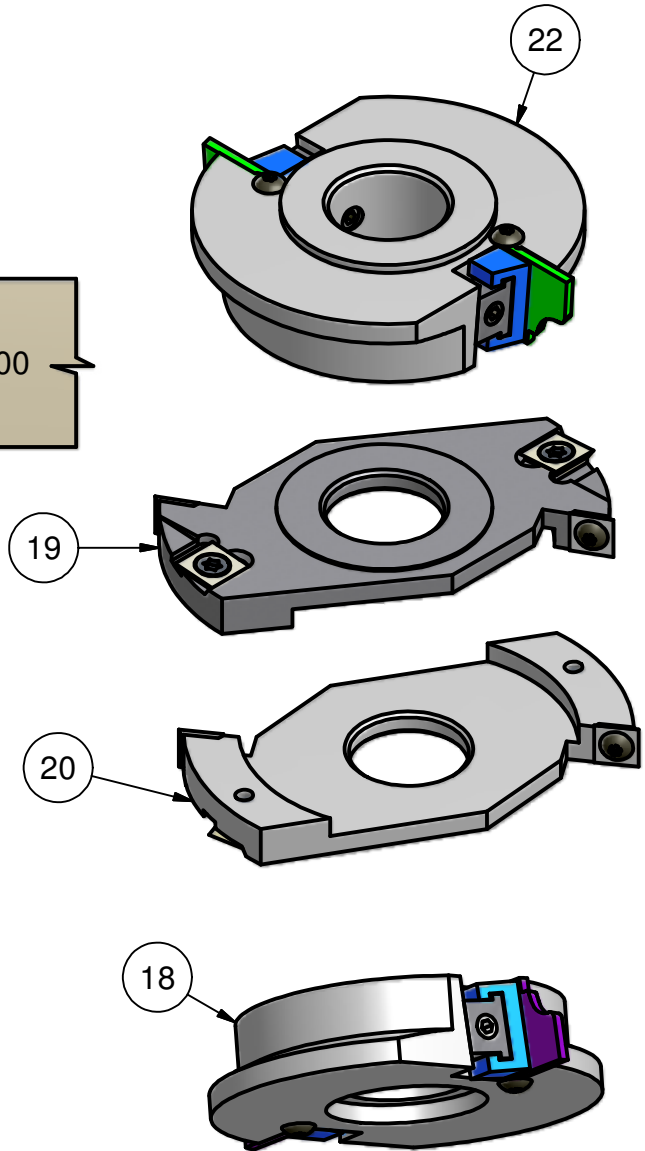
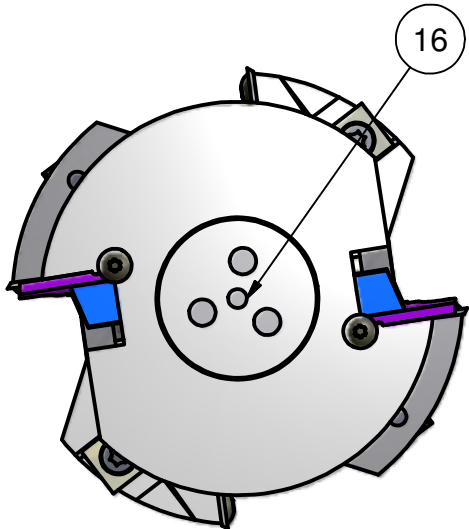

THIS DRAWING IS PROPERTY OF EW TOOLING, INC. AND MUST NOT BE USED IN ANY WAY DETRIMENTAL TO OUR INTERESTS

PARTS LIST DRAWING

E.W. TOOLING, INC.
Cutting tools for the woodworking industry

Originate: 12/09

Last edit: 12/14/09

EW P/N: 182-326

Tips: Carbide inserts

Cust P/N: Profile A 1.75" wood

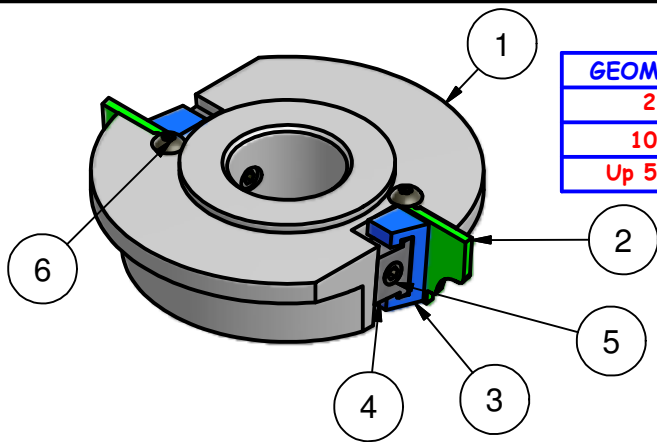

Parts List		
ITEM	QT	PART NUMBER
1	1	182-326 A top body CW
2	2	182-330 Insert CW
3	2	EW #1 wedge
4	2	EW #1 clamp
5	2	3125x24x1 clamp screw
6	2	3.5 mm X 6mm BH

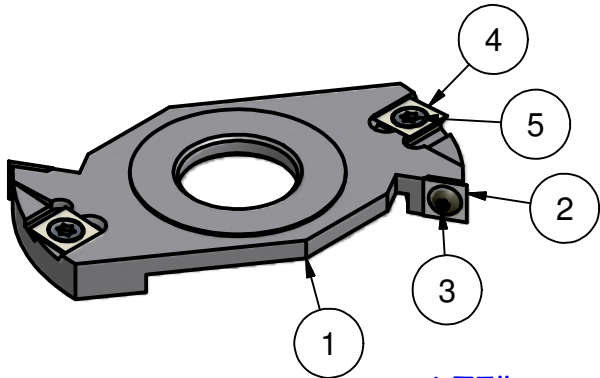

Parts List		
ITEM	QTY	PART NUMBER
1	1	182-326 B Groover body CW
2	2	12x12x1.5-35 deg
3	2	3.5 mm X 6mm BH
4	2	14x14x2
5	2	075-993 6x10-Flat Head Screw

1.75" wood uses both B & C assemblies

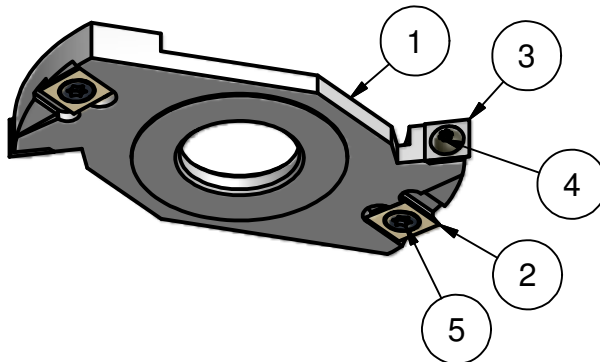

Parts List		
ITEM	QTY	PART NUMBER
1	1	182-326 C Groover body CW
2	2	14x14x2
3	2	12x12x1.5-35 deg
4	2	3.5 mm X 6mm BH
5	2	075-993 6x10-Flat Head Screw

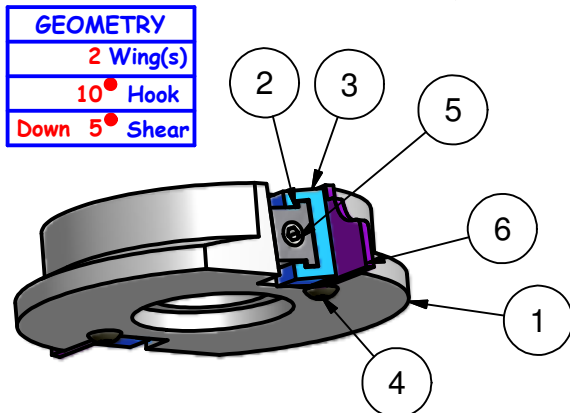

Parts List		
ITEM	QT	PART NUMBER
1	1	182-326 E Bottom body CW
2	2	EW #1 clamp
3	2	EW #1 wedge
4	2	3.5 mm X 6mm BH
5	2	3125x24x1 clamp screw
6	2	182-331 Insert CW

THIS DRAWING IS PROPERTY OF EW TOOLING, INC. AND MUST NOT BE USED IN ANY WAY DETRIMENTAL TO OUR INTERESTS

E.W. TOOLING, INC.
Cutting tools for the woodworking industry

PARTS LIST DRAWING

Originate: 12/09

Last edit: 12/14/09

EW P/N: 182-326

Tips: Carbide inserts

Cust P/N: Profile A 1.75" wood

GEOMETRY	
2	Wing(s)
10°	Hook
5°	Shear

Parts List		
ITEM	QTY	PART NUMBER
2	1	Lacey 1.250 toolholder
3	1	Lacey Toolholder Small Endcap
4	1	182-326 CW body A assembly
5	1	182-326 CW body E assembly
6	1	Lacey Stile 2.25" wood
7	1	182-326 Groover body D assembly
8	1	182-326 Groover body C assembly
9	1	182-326 B Groover body assembly
10	1	Shim 1.25x1.75x.010 (not shown)
11	1	Lacey Stile Spacer

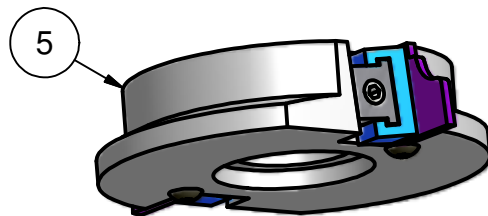
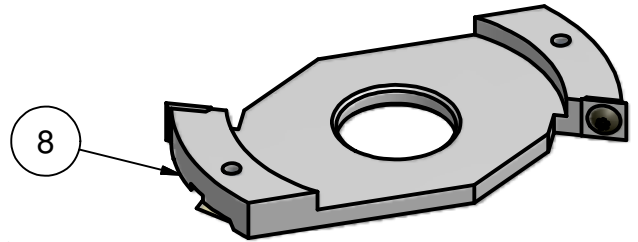
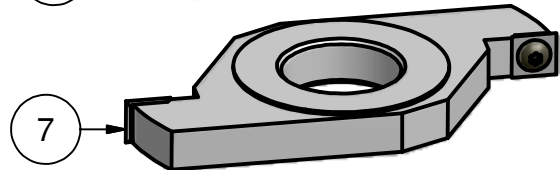
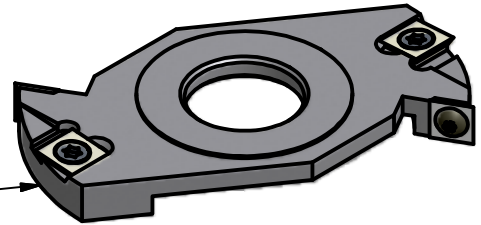
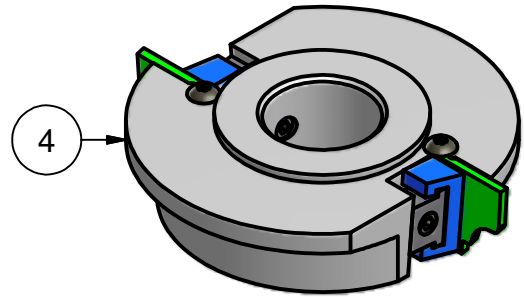
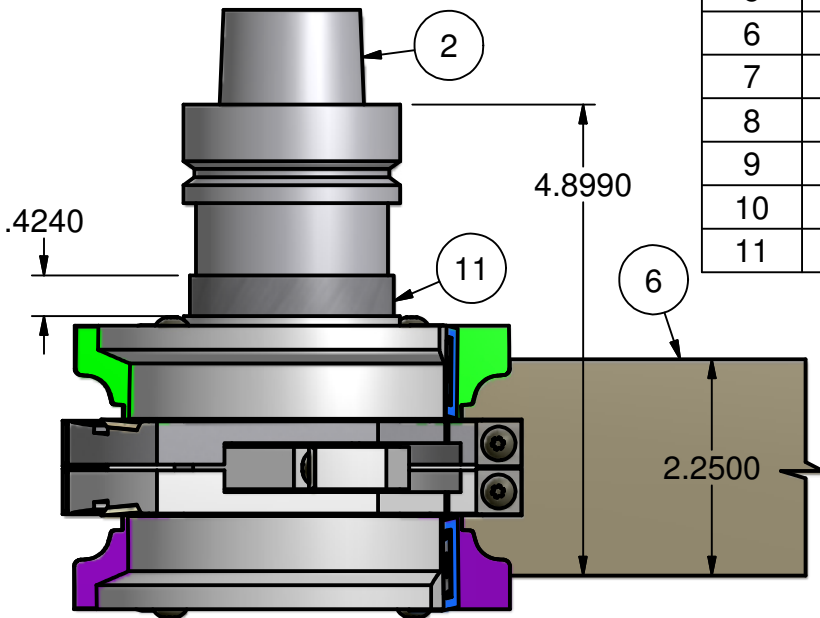

SCALE 1 / 2
The minor diameter is 90mm

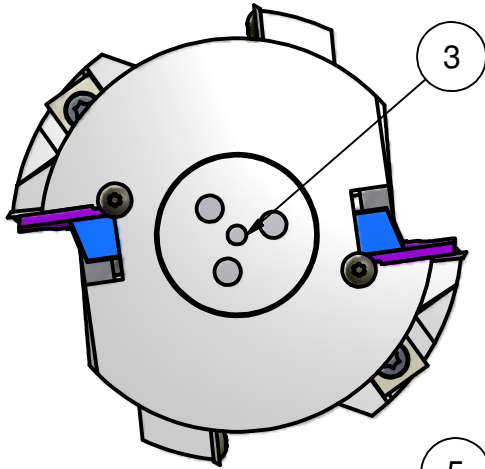

THIS DRAWING IS PROPERTY OF EW TOOLING, INC. AND MUST NOT BE USED IN ANY WAY DETRIMENTAL TO OUR INTERESTS

PARTS LIST DRAWING

E.W. TOOLING, INC.
Cutting tools for the woodworking industry

Originate: 12/09

Last edit: 12/14/09

EW P/N: 182-326

Tips: Carbide inserts

Cust P/N: Profile A 2.25" wood

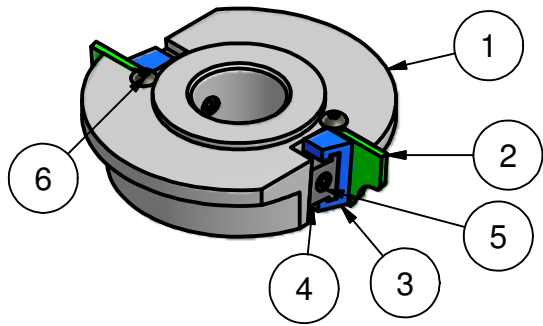

GEOMETRY
2 Wing(s)
10 Hook
Up 5 Shear

Parts List		
ITEM	QTY	PART NUMBER
1	1	182-326 A top body CW
2	2	182-330 Insert CW
3	2	EW #1 wedge
4	2	EW #1 clamp
5	2	3125x24x1 clamp screw
6	2	3.5 mm X 6mm BH

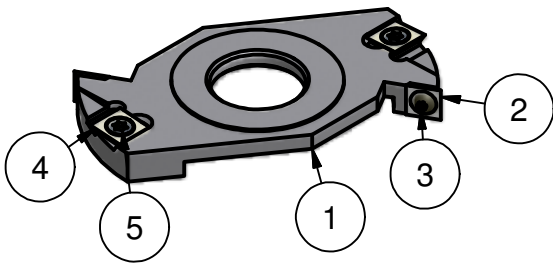

Parts List		
ITEM	QTY	PART NUMBER
1	1	182-326 B Groover body CW
2	2	12x12x1.5-35 deg
3	2	3.5 mm X 6mm BH
4	2	14x14x2
5	2	075-993 6x10-Flat Head Screw

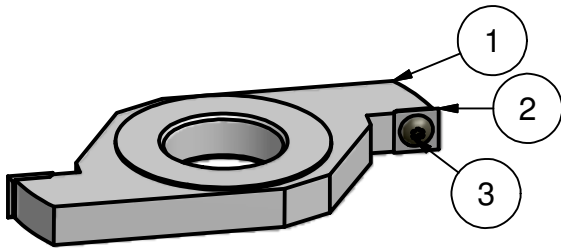

Parts List		
ITEM	QTY	PART NUMBER
1	1	182-326 D Groover body CW
2	2	12x12x1.5-35 deg
3	2	3.5 mm X 6mm BH

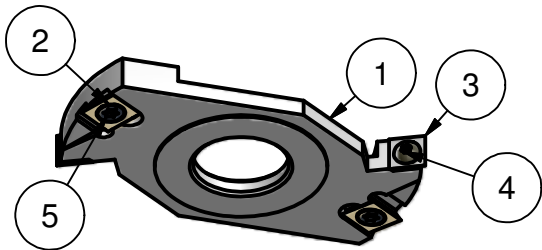

Parts List		
ITEM	QTY	PART NUMBER
1	1	182-326 C Groover body CW
2	2	14x14x2
3	2	12x12x1.5-35 deg
4	2	3.5 mm X 6mm BH
5	2	075-993 6x10-Flat Head Screw

GEOMETRY
2 Wing(s)
10 Hook
Down 5 Shear

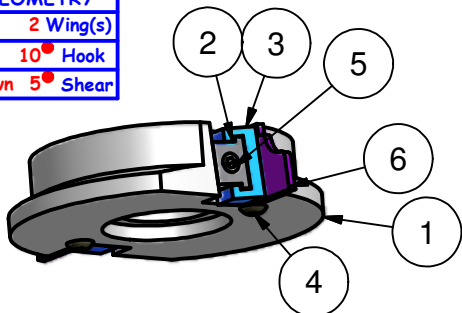

Parts List		
ITEM	QTY	PART NUMBER
1	1	182-326 E Bottom body CW
2	2	EW #1 clamp
3	2	EW #1 wedge
4	2	3.5 mm X 6mm BH
5	2	3125x24x1 clamp screw
6	2	182-331 Insert CW

THIS DRAWING IS PROPERTY OF EW TOOLING, INC. AND MUST NOT BE USED IN ANY WAY DETRIMENTAL TO OUR INTERESTS

E.W. TOOLING, INC.
Cutting tools for the woodworking industry

PARTS LIST DRAWING

Originate: 12/09

Last edit: 12/14/09

EW P/N: 182-326

Tips: Carbide inserts

Cust P/N: Profile A 2.25" wood