

182 Hall Manufacturing Solutions

EW p/n: 182-400

Cust. p/n: 182-400

Insert type: 30 x 30.5 x 2mm JONALLOY with 2 holes @ 14mm

Must have bottom bevel

E.W. Tooling, Inc.

Cutting tools for the woodworking industry

Create date: 7-22-10 Edit date: 7-22-10

Insert Record

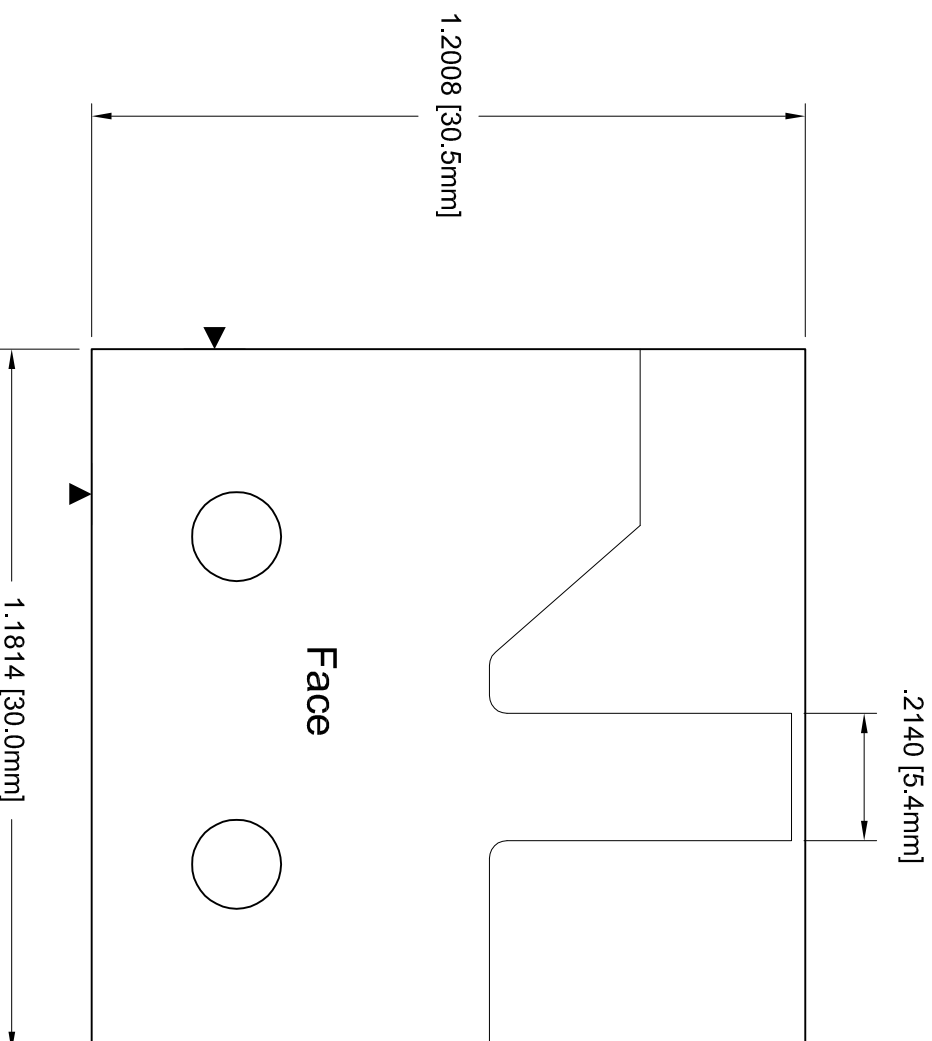

182 Hall Manufacturing Solutions

EW p/n: 182-401

Cust. p/n: 182-401

Insert type: 30 x 30.5 x 2mm JONALLOY with 2 holes @ 14mm

Must have bottom bevel

E.W. Tooling, Inc.

Cutting tools for the woodworking industry

Create date: 7-22-10 Edit date: 7-22-10

Insert Record

